

TM9-2320-211-34P

(4) (5) (6) (7) (8) (9) (10)

of inc. allowance allowance alw maint  
meas in Unit per alw  
100 per (a) (b)  
equip100 Figure Item  
cnt-equipNo. No.

(a) (b) (c) (a) (b) (c)

1-20 21-5(51-10(1-20 21-5(51-10(gcy

Reference Number & Mfr. Code Usable On Code

2001-HOIST, WINCH, CRANE ASSEMBLY-CONTINUED

|     |             |   |          |    |   |   |   |   |   |   |   |    |    |     |    |
|-----|-------------|---|----------|----|---|---|---|---|---|---|---|----|----|-----|----|
| P-O | 3130-227-40 | BLOCK,PILLOW:REAR DRIVE SHAFT<br>6Y1127SA (24076)                   | HA,FJ,JA | EA | 1 | * | * | * | * | * | * | 4  | 8  | 224 | 6  |
| P-O | 5310-067-95 | NUT,SELF-LOCKING:PILLOW BLOCK<br>MS51922-37 (96906)                 | HA,FJ,JA | EA | 2 | * | * | * | * | * | * | 6  | 10 | 224 | 7  |
| P-O | 5310-167-08 | WASHER,FLAT:PILLOW BLOCK<br>502268 (21450)                          | HA,FJ,JA | EA | 2 | * | * | * | * | * | * | 6  | 10 | 224 | 8  |
| P-O | 5305-716-81 | SCREW,CAP,HEXAGON HEAD:<br>PILLOW BLOCK<br>MS90726-118 (96906)      | HA,FJ,JA | EA | 2 | * | * | * | * | * | * | 6  | 10 | 224 | 9  |
| P-F | 2530-741-39 | CHAMBER,AIR BRAKE:<br>7413932 (19207)                               | HA,FJ,JA | EA | 1 | * | * | * | * | * | * | 6  | 10 | 225 | 1  |
| P-F | 2530-367-36 | BELLOWS,RUBBER:ROD END<br>7704076 (19207)                           | HA,FJ,JA | EA | 1 | * | * | * | * | * | * | 10 | 40 | 225 | 2  |
| X1  |             | YOKE:CHAMBER,AIR BRAKE<br>741393 (19207)                            | HA,FJ,JA |    | 1 |   |   |   |   |   |   |    |    | 225 | 3  |
| P-F | 2520-509-30 | VALVE ASSEMBLY,VACUUM:<br>HAND CONTROL,TENSIONER<br>7003615 (19207) | HA,FJ,JA | EA | 1 | * | * | * | * | * | * | 6  | 10 | 226 | 1  |
| P-F | 2590-513-57 | CYLINDER ASSEMBLY,ACTUATOR:<br>8327979 (19207)                      | AK       | EA | 2 | * | * | * | * | * | * | 6  | 10 | 227 | 1  |
| P-F | 4730-740-90 | ADAPTER BUSHING:CYLINDER BASE<br>7409058 (19207)                    |          | EA | 2 | * | * | * | * | * | * | 4  | 8  | 227 | 2  |
| X1  |             | WASHER,HOIST PISTON PLUG:<br>7409080 (19207)                        |          |    | 3 |   |   |   |   |   |   |    |    | 227 | 3  |
| P-F | 4730-335-18 | RESTRICTOR,FLUID:ORIFICE<br>8327982 (19207)                         |          | EA | 1 | * | * | * | * | * | * | 6  | 10 | 227 | 4  |
| P-F | 5315-849-98 | PIN,COTTER:<br>MS24665-498 (96906)                                  |          | EA | 1 | * | * | * | * | * | * | 8  | 10 | 227 | 5  |
| P-F | 3110-100-61 | BALL,BEARNGING:HOIST CYLINDER<br>MS19055-59 (96906)                 |          | EA | 2 | * | * | * | * | * | * | 6  | 10 | 227 | 6  |
| P-F | 2590-597-40 | SPRING,HELICAL,COMPRESSOR:<br>BY PASS PLUNGER<br>7409054 (19207)    |          | EA | 2 | * | * | * | * | * | * | 8  | 10 | 227 | 7  |
| P-F | 4730-335-18 | PLUG,PIPE:CHECK VALVE<br>8327981 (19207)                            |          | EA | 3 | * | * | * | * | * | * | 8  | 10 | 227 | 8  |
| X1  |             | CYLINDER:HOIST<br>8720944 (19207)                                   |          |    | 1 |   |   |   |   |   |   |    |    | 227 | 9  |
| P-F | 5330-291-24 | PACKING,PREFORMED:CYLINDER HEAD<br>8327984 (19207)                  |          | EA | 1 | * | * | * | * | * | * | 8  | 20 | 227 | 10 |

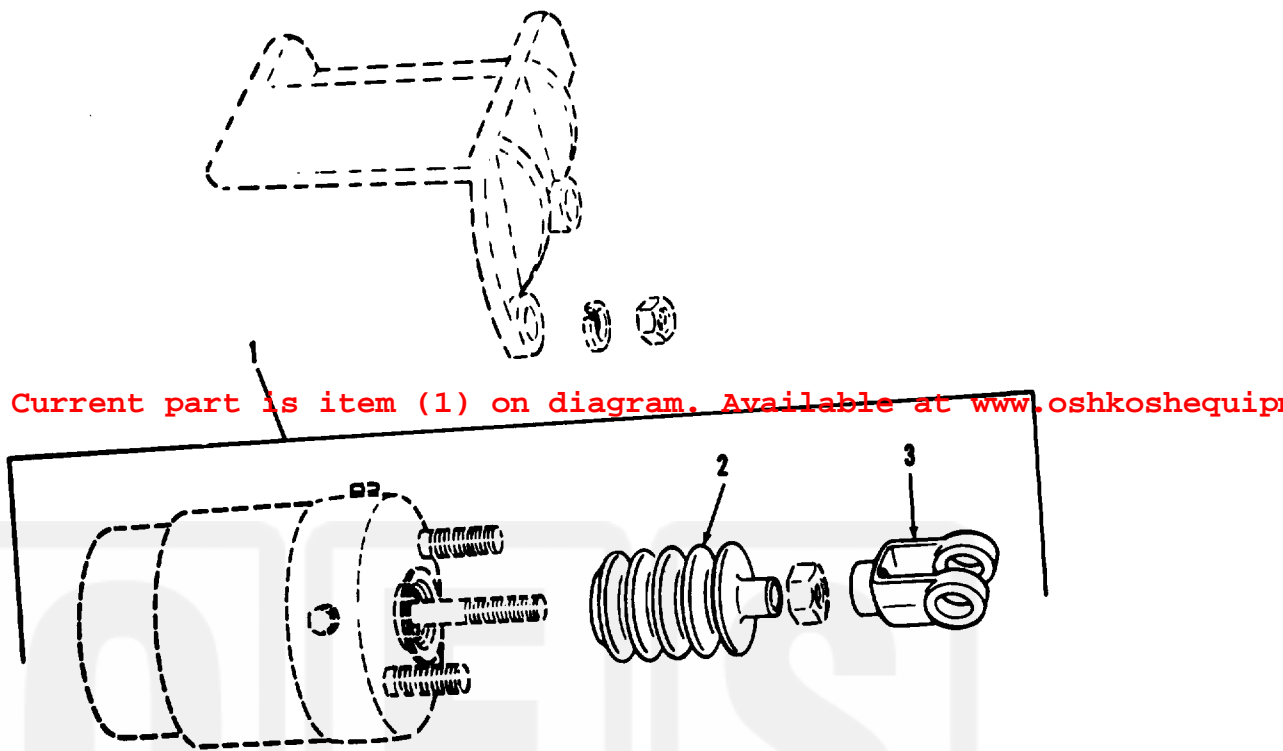

AT 47320

**Figure 225. Rotochamber assembly.**

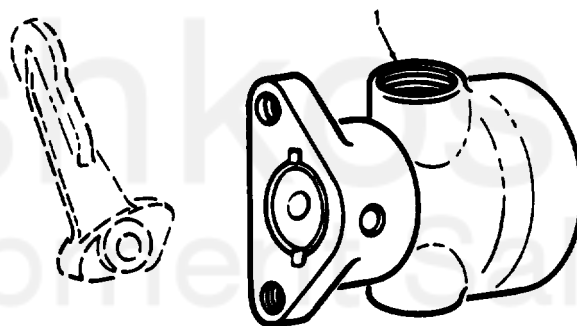

AT 47321

**Figure 226. Vacuum control valve.**