

TM9-2320-211-34P

(4) (5) (6) (7) (8) (9) (10)

of inc. allowance allowance alw maint  
meas in Unit per alw  
100 per (a) (b)  
equip100 Figure Item  
cnt-equipNo. No.

(a) (b) (c) (a) (b) (c)

1-20 21-5(51-10(1-20 21-5(51-10(gcy

Reference Number & Mfr. Code Usable On Code

2001-HOIST, WINCH, CRANE ASSEMBLY-CONTINUED

P-F	5305-269-32	SCREW,CAP,HEXAGON HEAD: CONTROL VALVE ADAPTER MS90725-69 (96906)	AK	EA	2	*	*	*	*	*	*	6	10	229	10
P-F	5305-269-32	SCREW,CAP HEXAGON HEAD: CONTROL VALVE ADAPTER MS90725-18 (96906)	AK	EA	1	*	*	*	*	*	*	6	10	229	11
X2-F		SCREW,CAP HEXAGON HEAD: CONTROL VALVE ADAPTER 8758397 (19207)	AK	EA	1	*	*	*	*	*	*			229	12
P-F	2520-740-90	VALVE,CONTROL ASSEMBLY: 7409083 (19207)	AK	EA	1	*	*	*	*	*	*	6	10	230	1
X1		PLUG, VALVE END CAP: (COMPONENT OF PARTS KIT, CONTROL VALVE FSN 2540-740-9205) 7728-2-10 (81336)			1									230	2
X1		SPRING, VALVE END CAP: (COMPONENT OF PARTS KIT CONTROL VALVE FSN 2540-740-9205) 7409073 (19207)			4									230	3
P-F	3110-100-61	BALL BEARING: (COMPONENT OF PARTS KIT CONTROL VALVE, FSN 2540-740-9205) MS19059-51 (96906)		EA	1	*	*	*	*	*	*	6		230	4
X1		CAP, VALVE END: (COMPONENT OF PARTS KIT CONTROL VALVE, FSN 2540-740-9205) 7409086 (19207)			1									230	5
X1		WASHER, FLAT: VALVE CAP (COMPONENT OF PARTS KIT CONTROL VALVE FSN 2540-740-9205) 7409080 (19207)			2									230	6
P-F	2590-179-35	SPOOL, VALVE CONTROL: (COMPONENT OF PARTS KIT CONTROL VALVE FSN 2540-740-9205) 102955R1 (31007)		EA	1	*	*	*	*	*	*	6		230	7
X1		BODY: CONTROL VALVE 7409084 (19207)			1									230	8
P-F	5365-403-57	PLUG, MACHINE: CONTROL VALVE 7409162 (19207)		EA	1	*	*	*	*	*	*	6	10	230	9

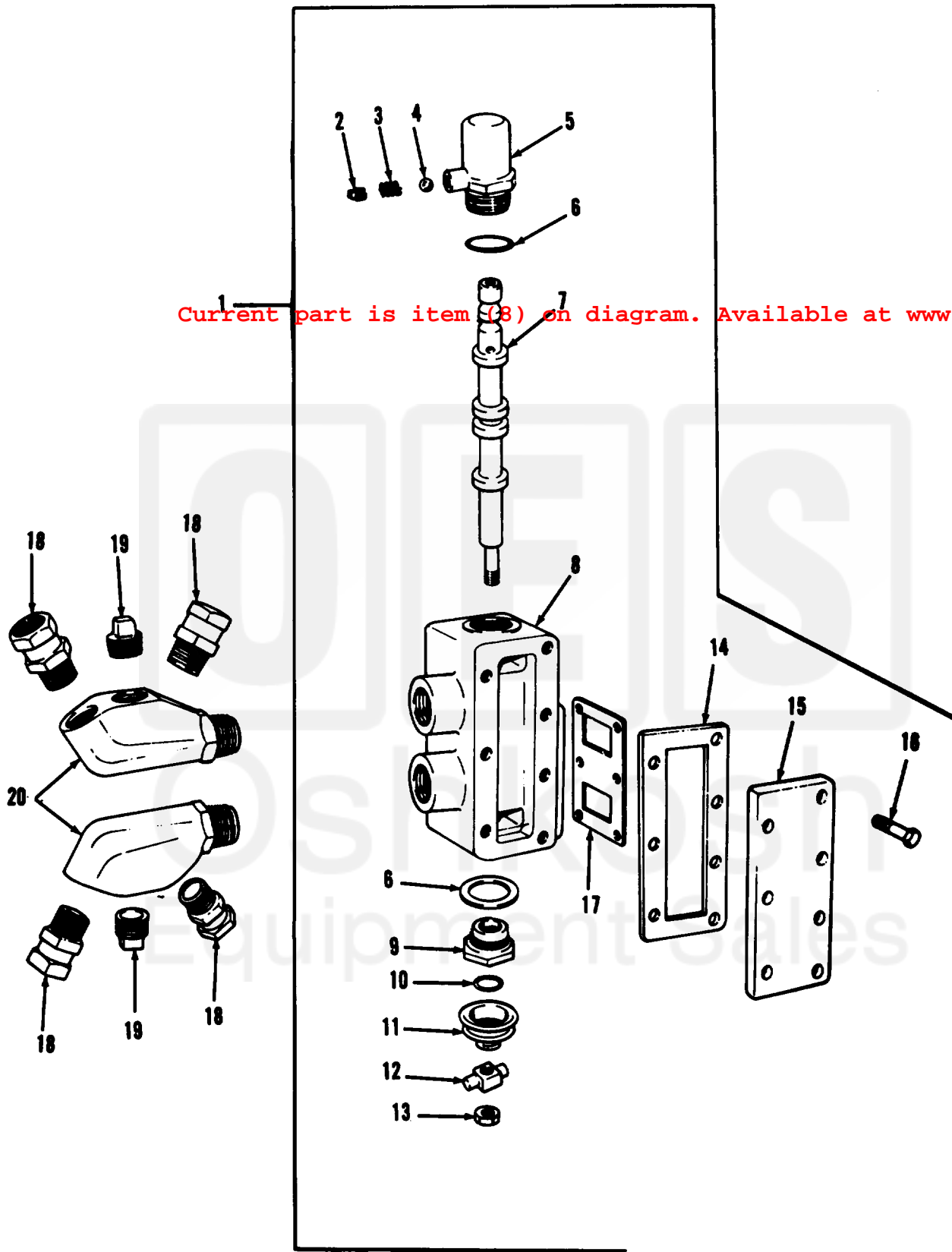

AT 47325

Figure 230. Hydraulic control valve.