

Current part is item (18) on diagram. Available at [www.oshkoshequipment.com](http://www.oshkoshequipment.com)

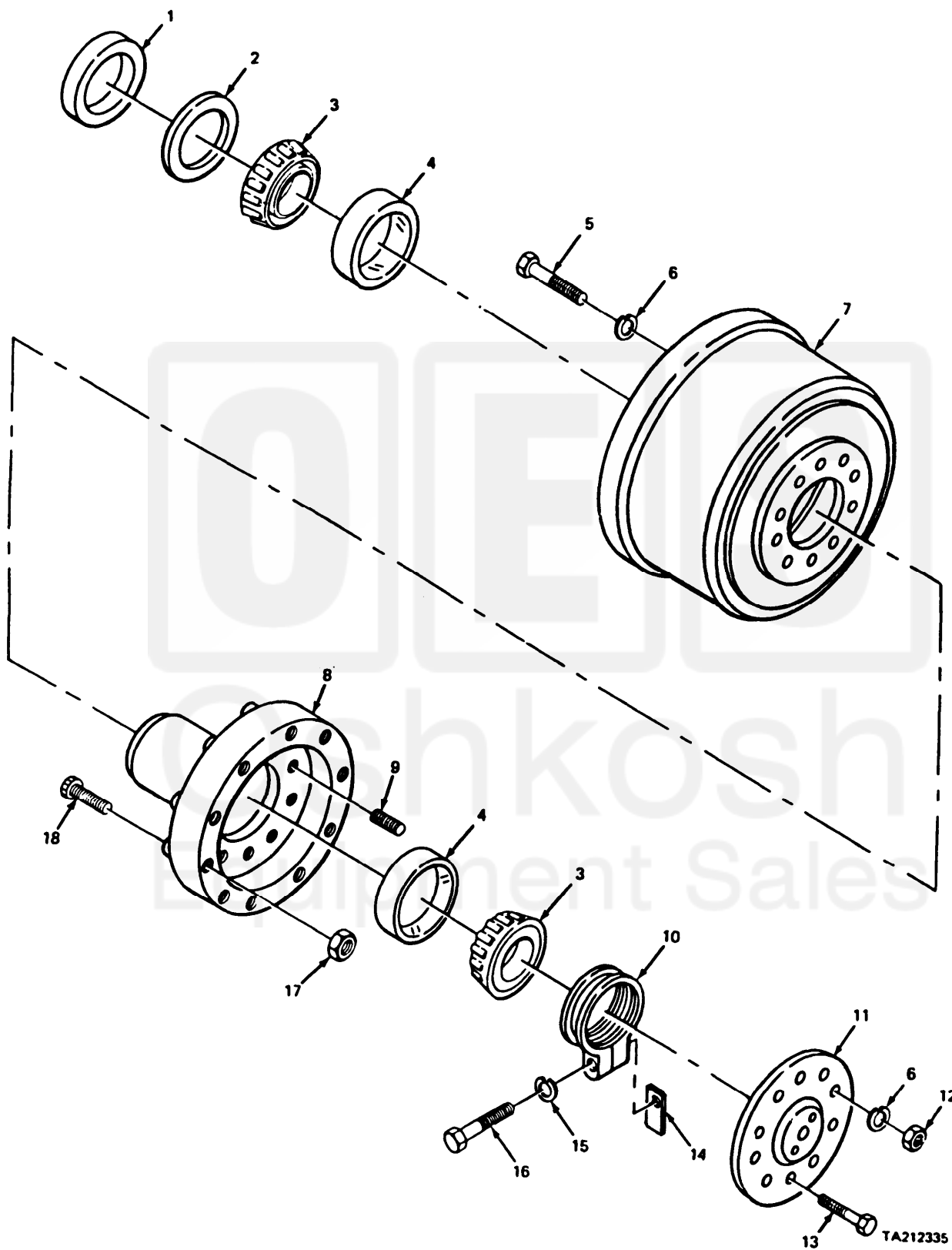

FIGURE 115. FRONT BRAKE DRUM AND HUB ASSEMBLY.

Current part is item (18) on diagram. Available at [www.oshkoshequipment.com](http://www.oshkoshequipment.com)

SECTION II

TM9-2320-270-20P

(1) ITEM NO.	(2) SMR CODE	(3) FSCM	(4) PART NUMBER	(5) DESCRIPTION AND USABLE ON CODE (UOC)	(6) QTY
GROUP 13 WHEELS					
GROUP 1311 WHEEL ASSEMBLY					
FIG. 115 FRONT BRAKE DRUM AND HUB ASSEMBLY					
1	PAOZZ	76680	455105	SEAL,PLAIN ENCASED HUB	2
2	PAOZZ	45152	21283-FX	SPACER,RING OIL SEAL,AXLE 1	2
3	PAOZZ	45152	570GX	BEARING,ROLLER,TAPE CONE,HUB,INNER AND OUTER	4
4	PAOZZ	60038	672	CUP,TAPERED ROLLER HUB,INNER AND OUTER AXLE 1	4
5	PAOZZ	45152	27882-A	SCREW,CAP,HEXAGON H	20
6	PFOZZ	45152	318B	WASHER,LOCK CAP ASSEMBLY AND AXLE HUB,AXLE 1	40
7	PAOZZ	45152	21002FX	BRAKE DRUM AXLE 1	2
8	PAOZZ	45152	63703CX	DRUM AND HUB ASSEMB AXLE 1	2
9	PAOZZ	45152	15518-F	STUD,PLAIN HUB TO HUB CAP ASSY, AXLE 1 (20)	20
10	PAOZZ	45152	574GX	NUT LOCK,ADJUSTABLE,OUTER HUB CONE, AXLE 1	2
11	PAOZZ	45152	571GX3W	HUB CAP,WHEEL HUB,AXLE 1	2
12	PAOZZ	45152	432-A-1	NUT,PLAIN,HEXAGON HUB TO AXLE SHAFT,AXLE 3 (8),AXLE 4 (8)	16
13	PAOZZ	45152	1867HX1	SCREW,CAP,HEXAGON H AXLE 1 (4)	4
14	PAOZZ	45152	367GX	LOCK PLATE OUTER HUB CONE, AXLE 1	2
15	PAOZZ	96906	MS35338-46	WASHER,LOCK OUTER HUB CONE ADJUSTABLE LOCK NUT, AXLE 1	2
16	PAOZZ	45152	863AX1	SCREW,CAP,HEXAGON H OUTER HUB CONE ADJUSTABLE LOCK NUT,AXLE 1	2
17	PAOZZ	09386	67012	NUT,PLAIN,SINGLE BA WHEEL,LEFT HAND,FRONT WHEELS	10
17	PAOZZ	09386	67011	NUT,PLAIN,SINGLE BA WHEEL,RIGHT HAND FRONT WHEELS	10
18	PAOZZ	45152	64331BX	STUD LEFT HAND	10
18	PAOZZ	45152	64330BX	STUD RIGHT HAND	10

END OF FIGURE