

(1) SMR Code	(2) Federal Stock Number	(3) Description	(4) Unit of Meas.	(5) Qty In Unit	(6) 15-day Maintenance alw	(7) Organizational Illustration No.	(a) 1-5	(b) 6-20	(c) 21-50	(d) 51-100	(a) Figure No.	(b) Item No.
Current part is item (10) on diagram. Available at <a href="http://www.oshkoshequipment.com">www.oshkoshequipment.com</a>												
Reference number & mfg. code			Usable on code									
1601-SPRINGS-CONTINUED												
PAOZZ	5310-734-6957	PLATE: GUIDE BRACKET 7346957 (19207)	HA,JA,BD	EA	4	*	*	*	*		147	9
PAOZZ	2510-277-9786	SPRING ASSEMBLY, LEAF: REAR 8327139 (19207)	HA,JA,BD	EA	2	*	*	*	*		147	10
PAOZZ	5306-446-8762	BOLT, MACHINE: LEAF SPRING 7017002 (19207)	HA,JA,BD	EA	2	*	*	*	*		147	11
PAOZZ	5310-700-7127	NUT: SADDLE "U" BOLT 7007127 (19207)	HA,JA,BD	EA	8	*	*	*	*		147	12
PAOZZ	5310-926-5885	WASHER,LOCK: SADDLE "U" BOLT MS35340-53 (96906)	HA,JA,BD	EA	8	*	*	*	*		147	13
PAOZZ	5310-732-0560	NUT,PLAIN,HEXAGON: LEAF SPRING MS51968-14 (96906)	A	EA	2	*	*	*	*		147	14
PAOZZ	5310-740-9615	WASHER,FLAT: 7409615 (19207)	A	EA	2	*	*	*	*		148	1
PAOZZ	5330-740-9312	WASHER,NONMETALLIC: 7409312 (19207)	A	EA	3	*	*	*	*		148	2
PAOZZ	2510-740-9606	RETAINER, PACKING: SEAT BEARING FELT 7409606 (19207)	A	EA	2	*	*	*	*		148	3
PAOZZ	2530-740-9553	RING,WIPER: HUB BEARING OIL SEAL 7979766 (19207)	A	EA	2	*	*	*	*		148	4
PAOZZ	2520-740-9550	SEAL,PLAIN,ENCASED:SEAT BEARING 7409550 (19207)	A	EA	2	*	*	*	*		148	5
PAOZZ	3110-198-1468	CONE AND ROLLERS, TAPERED 712286 (21450)	A	EA	2	*	*	*	*		148	6
PAOZZ	5306-740-9608	BOLT, MACHINE: SPRING SEAT 7409608 (19207)	A	EA	4	*	*	*	*		148	7
PAOZZ	5310-820-6653	WASHER,LOCK: SPRING SEAT MS35338-55 (96906)	A	EA	4	*	*	*	*		148	8
PAOZZ	2510-741-8773	SEAT ASSEMBLY, BEARING CUP: 7418773 (19207)		EA	2	*	*	*	*		148	9
PAOZZ	3110-142-4390	CUP,TAPERED ROLLER BEARING: 706691 (12742)	A	EA	2	*	*	*	*		148	10
PAOZZ	3110-100-0649	CONE AND ROLLERS, TAPERED: 705155 (12742)	A	EA	2	*	*	*	*		148	11
PAOZZ	5310-353-2297	NUT,PLAIN,OCTAGON: 7409606 (19207)	A	EA	2	*	*	*	*		148	12
PAOZZ	5310-700-7089	WASHER, KEY:SEAT NUT 5139123 (19207)	A	EA	2	*	*	*	*		148	13
PAOZZ	5310-353-2427	NUT,PLAIN,OCTAGON: 7346885 (19207)	A	EA	2	*	*	*	*		148	14

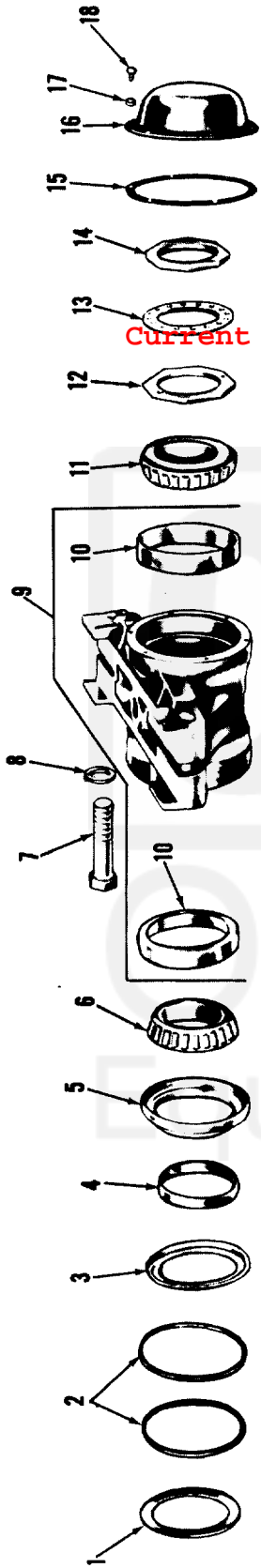

AT 47267

Current part is item (10) on diagram. Available at [www.oshkoshequip.com](http://www.oshkoshequip.com)

Figure 148. Rear spring seat and bearing.

Current part is item (10) on diagram. Available at [www.oshkoshequip.com](http://www.oshkoshequip.com)