

Section II.

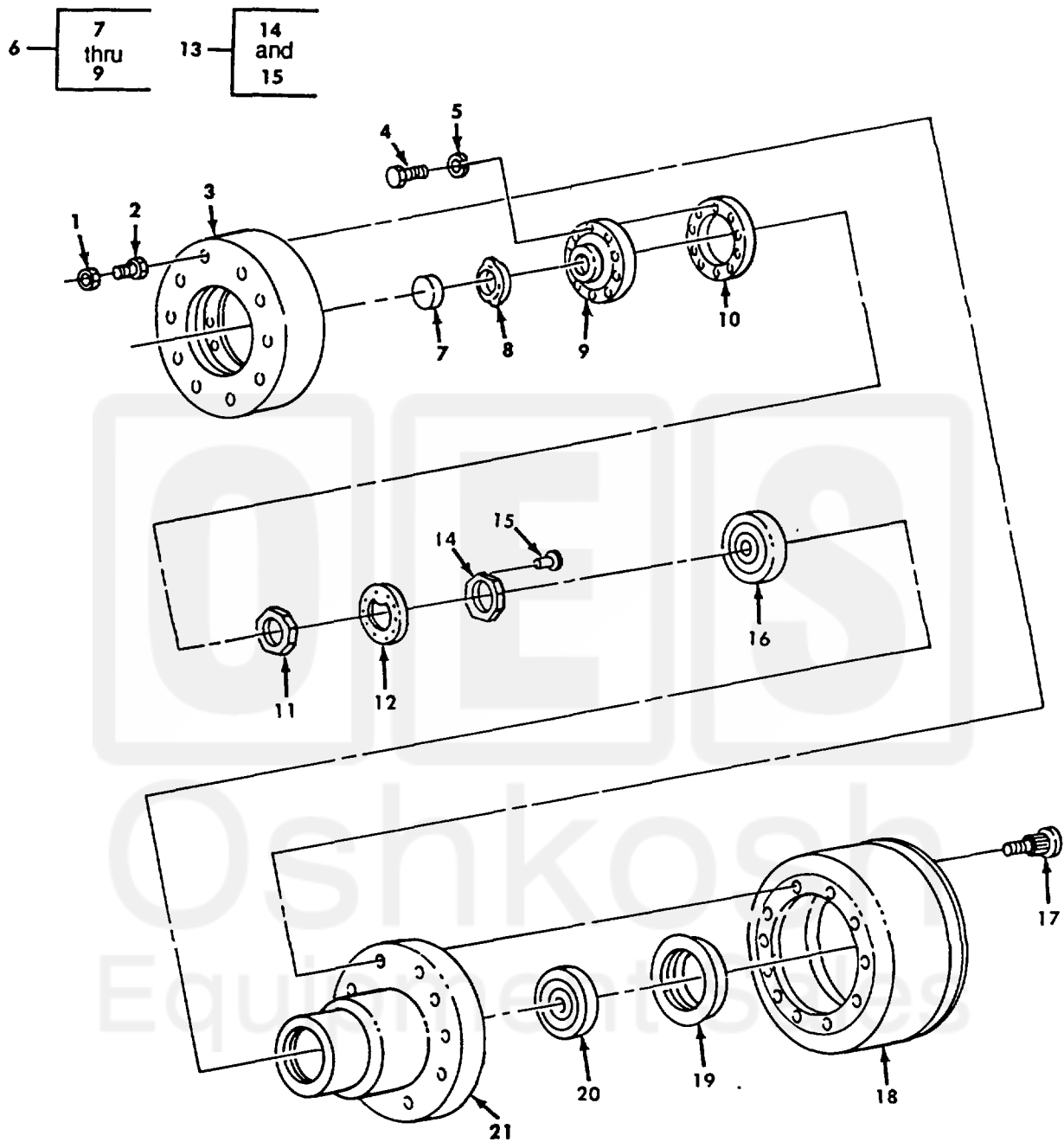

Figure 293. Front Wheel Hub and Drum Assembly (M939, M939A1).

SECTION II					TM 9-2320-272-24P-1	
(1)	(2)	(3)	(4)	(5)	(6)	(7)
ITEM NO	SMR CODE	NSN	CAGEC	PART NUMBER	DESCRIPTION AND USABLE ON CODES (UOC)	QTY
GROUP 1311 WHEEL ASSEMBLY						
FIG. 293 FRONT WHEEL HUB AND DRUM ASSEMBLY (M939 , M939A1)						
1	PAOZZ	5310013753107	24614	3A7313	NUT, PLAIN, SINGLE BA WHEEL STUD, R.H..... UOC:DAA, DAB, DAC, DAD, DAE, DAF, DAG, DAH, DAJ, DAK, DAL, DAW, DAX, V12 , V13, V14, V15, V16, V17, V18, V19, V20, V21 , V22, V24, V25	10
1	PAOZZ	5310002737771	78500	1199G111	NUT, PLAIN, SINGLE BA WHEEL STUD, L.H..... UOC: DAA, DAB, DAC, DAD, DAE, DAF, DAG, DAH, DAJ, DAK, DAL, DAW, DAX, V12, V13 , V14, V15, V16, V17, V18, V19, V20, V21, V22, V24, V25	10
1	PAOZZ	5310012298029	96906	MS51983-8	NUT, PLAIN, SINGLE BA WHEEL STUD, R.H. 10 UOC :V39	
1	PAOZZ	5310012705463	58536	A-A-52427	NUT, PLAIN, SINGLE BA WHEEL STUD, L.H..... UOC :V39	10
2	PAOZZ	2530003591162	78500	1199J114C	NUT, CAP, DUAL WHEEL, R.H	10
2	PAOZZ	2530006931029	52304	10709	NUT, CAP, DUAL WHEEL, L.M	10
3	PAOZZ	2530007411105	78500	3280-B-1978	ADAPTER, BRAKE DRUM	2
4	PAOZZ	5306001829267	19207	10896726	BOLT, MACHINE	20
5	PAOZZ	5310000034094	01276	210104-8S	WASHER, LOCK	20
6	PAOZZ	2520007346991	19207	7346991	FLANGE, COMPANION, VE	2
7	PAOZZ	5340007346992	19207	7346992	.PLUG, EXPANSION..... UOC: DAA, DAB, DAC, DAD, DAE, DAF, DAG, DAH, DAJ, DAK, DAL, DAW, DAX, V12 , V13 , V14 , V15, V16, V17, V18, V19, V20, V21, V24, V25, V39	1
8	PAOZZ	5330002913273	96906	MS29513-229	.PACKING, PREFORMED	1
9	XAOZZ		19207	8758278	.FLANGE ASSEMBLY, COMPANION, UN NHA..... P/N 7346991 19207	1
10	PAOZZ	5330013779775	14153	02764	GASKET, NON-ASBESTOS	2

SECTION II					TM 9-2320-272-24P-1	
(1)	(2)	(3)	(4)	(5)	(6)	(7)
ITEM NO	SMR CODE	NSN	CAGEC	PART NUMBER	DESCRIPTION AND USABLE ON CODES (UOC)	QTY
					UOC:DAA, DAB, DAC, DAD, DAE, DAF, DAG, DAH, DAJ, DAK, DAL, DAW, DAX, V12, V13, V14, V15, V16, V17, V18, V19, V20, V21, V22, V24, V25, V39	
11	PAOZZ	5310003532427	19207	7979263	NUT, PLAIN, OCTAGON	2
					UOC: DAA, DAB, DAC, DAD, DAE, DAF, DAG, DAH, DAJ, DAK, DAL, DAW, DAX, V12, V13, V14, V15, V16, V17, V18, V19, V20, V21, V22, V24, V25, V39	
12	PAOZZ	5310007007089	19207	5139123	WASHER, KEY, WHEEL BEARING LOCK	2
					UOC: DAA, DAB, DAC, DAD, DAE, DAF, DAG, DAH, DAJ, DAK, DAL, DAW, DAX, V12, V13, V14, V15, V16, V17, V18, V19, V20, V21, V22, V24, V25, V39	
13	PAOZZ	5310003740836	19207	7979308	NUT, PLAIN, OCTAGON	2
					UOC: DAA, DAB, DAC, DAD, DAE, DAF, DAG, DAH, DAJ, DAK, DAL, DAW, DAX, V12, V13, V14, V15, V16, V17, V18, V19, V20, V21, V22, V24, V25, V39	
14	XAOZZ	5310011350049	19207	7979309	.NUT, PLAIN, OCTAGON	1
					UOC: DAA, DAB, DAC, DAD, DAE, DAF, DAG, DAH, DAJ, DAK, DAL, DAW, DAX, V12, V13, V14, V15, V16, V17, V18, V19, V20, V21, V22, V24, V25, V39	
15	PAOZZ	5315010587268	19207	7979310	.PIN, ADJUSTMENT, OUTER WHEEL.....	1
					BEARING NUT	
					UOC:DAA, DAB, DAC, DAD, DAE, DAF, DAG, DAH, DAJ, DAK, DAL, DAW, DAX, V12, V13, V14, V15, V16, V17, V18, V19, , 20, V21, V22, V24, V25, V39	
16	PAOZZ	3110001004223	96906	MS19081-181	BEARING, ROLLER, TAPE	2
					UOC: DAA, DAB, DAC, DAD, DAE, DAF, DAG, DAH, DAJ, DAK, DAL, DAW, DAX, V12, V13, V14, V15, V16, V17, V18, V19, , 20, V21, V22, V24, V25, V39	
17	PAOZZ	5307011424783	78500	20X-1529	STUD, LEFT FRONT WHEEL	10
					UOC:V39	
17	PAOZZ	5307011424784	78500	20X-1528	STUD, RIGHT FRONT WHEEL	10
					UOC:V39	
17	PAOZZ	5306012715842	78500	20X-1815-Z	STUD, LEFT FRONT WHEEL	10
					UOC: DAA, DAB, DAC, DAD, DAE, DAF, DAG, DAH, DAJ, DAK, DAL, DAW, DAX, V12, V13, V14, V15, V16, V17, V18, V19, V20, V221, V22, V2 2, V2 5	
17	PAOZZ	5306012715843	78500	20X-1816-Z	BOLT, RIBBED, SHOULDE, RIGHT FRONT	10
					WHEEL	
					UOC: DAA, DAB, DAC, DAD, DAE, DAF, DAG, DAH, DAJ, DAK, DAL, DAW, DAX, V12, V13, V14, V15, V16, V17, V18, V19, V20, V21, V22, V24, V25	
18	PAOZZ	2530011346570	78500	3219-C-4345	BRAKE DRUM	2
					UOC: DAA, DAB, DAC, DAD, DAE, DAF, DAG, DAH, DAJ, DAK, DAL, DAW, DAX, V12, V13, V14, V15, V16, V17, V18, V9, V20, V21, V22, V24, V25, V39	

SECTION II					TM 9-2320-272-24P-1	
(1)	(2)	(3)	(4)	(5)	(6)	(7)
ITEM NO	SMR CODE	NSN	CAGEC	PART NUMBER	DESCRIPTION AND USABLE ON CODES (UOC)	QTY
19	PAOZZ	533001448350	19207	12375801	SEAL, PLAIN, ENCASED UOC:DAA, DAB, DAC, DAD, DAE, DAF, DAG, DAH, DAJ, DAK, DAL, DAW, DAX, V12, V13, V14, V15, V16, V17, V18, V19, V20, V21, V22, V24, V25, V39.....	2
20	PAOZZ	3110006898250	96906	MS19081-182	BEARING, ROLLER, TAPE, INNER UOC:DAA, DAB, DAC, DAD, DAE, DAF, DAG, DAH, DAJ, DAK, DAL, DAW, DAX, V12, V13, V14, V15, V16, V17, V18, V19, V20, V21, V22, V24, V25, V39.....	2
21	PAOZZ	3040011391611	78500	A333-T-2334	HUB, FRONT WHEEL UOC:DAA, DAB, DAC, DAD, DAE, DAF, DAG, DAH, DAJ, DAK, DAL, DAW, DAX, V12, V13, V14, V15, V16, V17, V18, V19, V20, V21, V22, V24, V25, V39.....	2

