

UNIT, DIRECT SUPPORT, AND GENERAL SUPPORT MAINTENANCE  
REPAIR PARTS AND SPECIAL TOOLS LIST  
TRUCK, 5-TON, 6X6, M809 SERIES TRUCKS (DIESEL)

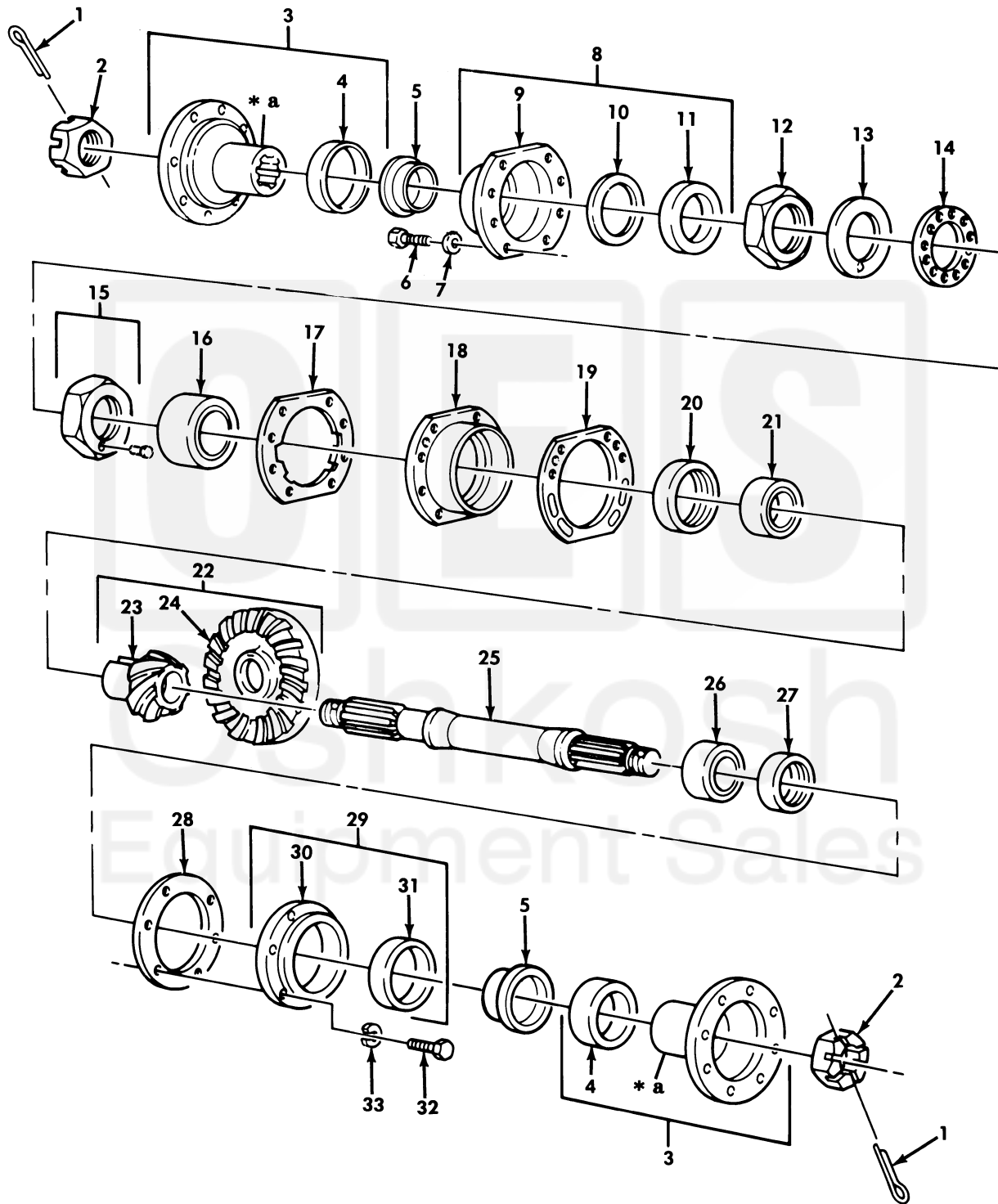

\* a PART OF ITEM 3

Figure 156. Front Axle Differential Through Shaft, Gears, and Flange Assemblies.

(1) ITEM NO	(2) SMR CODE	(3) NSN	(4) CAGEC	(5) PART NUMBER	(6) DESCRIPTION AND USABLE ON CODE (UOC)	(7) QTY
GROUP 1002 DIFFERENTIAL						
FIG. 156 FRONT AXLE DIFFERENTIAL THROUGH SHAFT, GEARS, AND FLANGE ASSEMBLIES						
1	PAFZZ	5315-00-059-0184	96906	MS24665-361	PIN, COTTER.....	2
2	PAFZZ	5310-00-282-5661	19207	7346893	NUT, PLAIN, SLOTTED, H.....	2
3	PAFZZ	2520-00-734-6802	78500	5WCS32-37A	FLANGE, COMPANION, VE.....	2
4	PAFZZ	2520-00-563-8309	19207	7535048	. DEFLECTOR, DIRT AND.....	1
5	PAFZZ	4910-01-313-4621	80201	99293	REPAIR KIT, SLEEVE.....	2
6	PAFZZ	5305-00-018-0178	24617	180178	SCREW, CAP, HEXAGON H.....	8
7	PAFZZ	5310-00-515-9627	38597	50-4-18-17-7	WASHER, FLAT FRONT DIFFERENTIAL.....	8
8	PAFZZ	3040-00-734-6897	19207	7346897	COVER ASSEMBLY.....	1
9	XAFZZ		19207	8758251	. COVER.....	1
10	PAFZZ	5330-00-419-5872	19207	10900396	. GASKET.....	1
11	PAFZZ	5330-01-023-0269	19207	12470105	. SEAL, PLAIN ENCASED.....	1
12	PAHZZ	5310-00-353-2427	19207	7979263	NUT, PLAIN, OCTAGON.....	1
13	PAHZZ	5310-00-147-3274	19207	8758258	WASHER, KEY.....	1
14	PAHZZ	5310-00-700-7089	19207	5139123	WASHER, KEY.....	1
15	PAHZZ	5310-00-374-0836	19207	7979308	NUT ASSY.....	1
16	PAHZZ	3110-00-100-4177	60038	497-493	BEARING, ROLLER, TAPE.....	1
17	KFHZZ		19207	7346886	GASKET PART OF KIT P/N 7346807.....	1
18	PAHZZ	3110-00-419-9471	19207	8758202	PLATE, RETAINING, BEA.....	1
19	KFHZZ		19207	7346888	SHIM PART OF KIT P/N 7346807.....	1
19	KFHZZ		19207	7346889	SHIM PART OF KIT P/N 7346807.....	1
19	KFHZZ		19207	7346890	SHIM PART OF KIT P/N 7346807.....	1
20	KFHZZ		19207	8758209	COLLAR 0.3670 PART OF KIT P/N 5704278.....	1
20	KFHZZ		19207	8758211	COLLAR 0.3690 PART OF KIT P/N 5704278.....	1
20	KFHZZ		19207	8758213	COLLAR 0.3710 PART OF KIT P/N 5704278.....	1
20	KFHZZ		19207	8758215	COLLAR 0.3730 PART OF KIT P/N 5704278.....	1
20	KFHZZ		19207	8758217	COLLAR 0.3750 PART OF KIT P/N 5704278.....	1
20	KFHZZ		19207	8758219	COLLAR 0.3770 PART OF KIT P/N 5704278.....	1
20	KFHZZ		19207	8758221	COLLAR 0.3790 PART OF KIT P/N 5704278.....	1
20	KFHZZ		19207	8758223	COLLAR 0.3810 PART OF KIT P/N 5704278.....	1
20	KFHZZ		19207	8758225	COLLAR 0.3830 PART OF KIT P/N 5704278.....	1
20	KFHZZ		19207	8758227	COLLAR 0.3850 PART OF KIT P/N 5704278.....	1
20	KFHZZ		19207	8758229	COLLAR 0.3870 PART OF KIT P/N 5704278.....	1
20	KFHZZ		19207	8758231	COLLAR 0.3890 PART OF KIT P/N 5704278.....	1
20	KFHZZ		19207	8758233	COLLAR 0.3910 PART OF KIT P/N 5704278.....	1
20	KFHZZ		19207	8758235	COLLAR 0.3930 PART OF KIT P/N 5704278.....	1
20	KFHZZ		19207	8758237	COLLAR 0.3950 PART OF KIT P/N 5704278.....	1
20	KFHZZ		19207	8758239	COLLAR 0.3970 PART OF KIT P/N 5704278.....	1
20	KFHZZ		19207	8758241	COLLAR 0.3990 PART OF KIT P/N 5704278.....	1
20	KFHZZ		19207	8758243	COLLAR 0.4010 PART OF KIT P/N 5704278.....	1