

(1) Illustration		(2) National stock number	(3) Description	(4) Qty furn equip
(a) Fig No.	(b) Item No			
B-1	3	3990-00-401-1503	BINDER, LOAD: Ratchet-type with 1 grab-hook and 1 pear-shaped link, 12-ton capacity (in stowage compartment w/cover on front deck) CPR 102265 (19207)	6
B-1	4	5510-00-491-0306	BLOCK, WOOD: 7 x 8 x 9 (in open stowage compartment on front deck) CPR 103023-1 (19207)	6
B-1	4	5510-00-491-0307	BLOCK, WOOD: 4 x 8 x 9 (in open stowage compartment on front deck) CPR 103023-2 (19207)	1
B-1	5	2510-00-741-7585	BOARD, WOOD: 24 x 24 x 2-5/8 (in open stowage compartment on front deck) 7417585 (19207)	2
B-1	6	2540-00-436-4586	CHAIN, LIFTING: 7/8 in. dia. chain link, 57-5/8 inches reach (in open stowage compartment below rigging block on rear deck) CPR 100423 (19207)	2
B-1	7	4010-00-449-6573	CHAIN, UTILITY: 3/4 in. dia. chain link, 12 ft. long (4 in open stowage compartment atop gooseneck) 8744250 (19207)	6
B-2	1	5120-00-224-1390	CROWBAR: 1 1/4 in. wide, 6 ft long (on left hand side of gooseneck, outboard) 11677049-1 (19207)	2
B-2	2	2540-00-490-0769	CURBING, TRACK GUIDE: (in open stowage compartment on front deck) CPR 101269 (19207)	8
B-2	3	5120-00-900-6097	HAMMER, BLACKSMITHS, DOUBLE FACE: 10-pound, 30 to 33 in. long handle (on left hand side of gooseneck, outboard) 11677050-2 (19207)	1
B-2	4	5340-00-682-1508	PADLOCK: with 2 keys, w/clevis and chain (on stowage compartment w/cover on front deck) MS35647-3 (96906)	1
B-2	5	4020-00-477-3734	ROPE, MANILA: 1/1-inch dia., 75 ft. long, w/whipped ends (in stowage compartment w/cover on front deck) CPR 102915 (19207)	1
B-2	6	4030-00-389-0312	SHACKLE, ANCHOR, SCREW PIN TYPE: 1 1/4 in. dia. pin (in stowage compartment w/cover on front deck) 8387707-2 (19207)	14
B-2	6	4030-00-389-0313	SHACKLE, ANCHOR, SCREW PIN TYPE: 2 1/4 in. dia. pin (in stowage compartment w/cover on front deck) 8387707-3 (19207)	2
B-2	6	4030-00-133-6518	SHACKLE, ANCHOR, BOLT TYPE: 2 1/4 in. dia. bolt (optional) (in stowage compartment w/cover on front deck) 10944788-11 (19207)	2
B-2	7	3940-00-181-2776	SNATCH BLOCK, RIGGING, WIRE ROPE: 1-in. dia. rope, 60-ton (in stowage compartment w/cover on front deck) CPR 100165 (19207)	1
B-2	8	4010-00-133-6736	TIE-DOWN ASSEMBLY, CARGO: 9/32 in. dia. chain, 43 in. long (in place, between ramp and trailer securing ramp in travel position) CPR 101228 (19207)	2
B-2	9	4910-00-262-0392	TRESTLE, ADJUSTABLE: 15 in. closed, 25 in. extended, 5-ton capacity (in open stowage compartment on front deck) MIL-T-14521 (81349)	1
B-2	10	5120-00-795-0664	WRENCH, SOCKET: 13/16 in. sq opening, 1 1/2 hex opening, 22 in. to 24 in. long (in stowage compartment w/cover on front deck) MIL-W-43105 (81349)	1

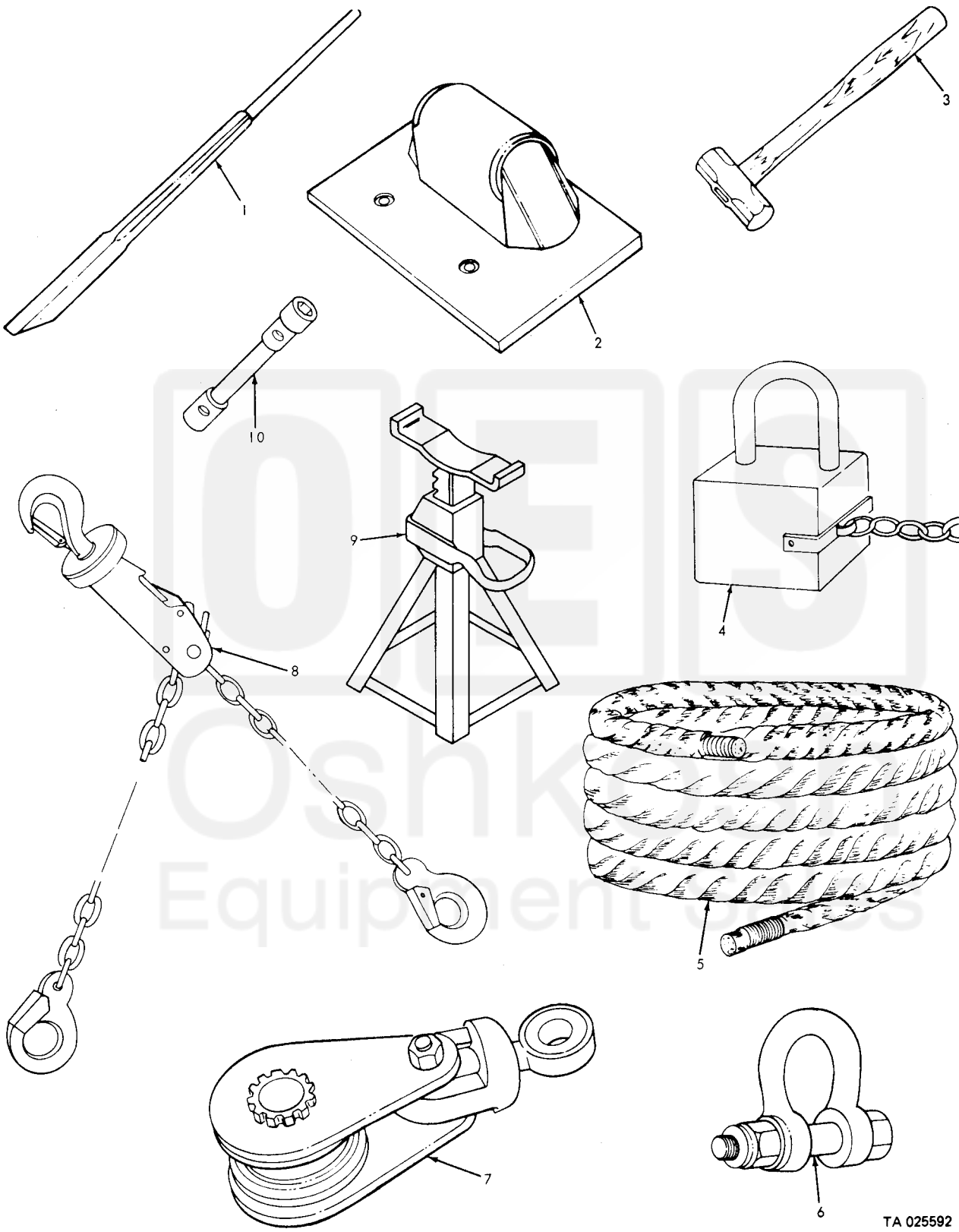

TA 025592

Figure B-2. Basic issue items.

B-4