

UNIT, DIRECT SUPPORT, AND GENERAL SUPPORT MAINTENANCE
REPAIR PARTS AND SPECIAL TOOLS LIST
TRUCK, 5-TON, 6X6, M809 SERIES TRUCKS (DIESEL)

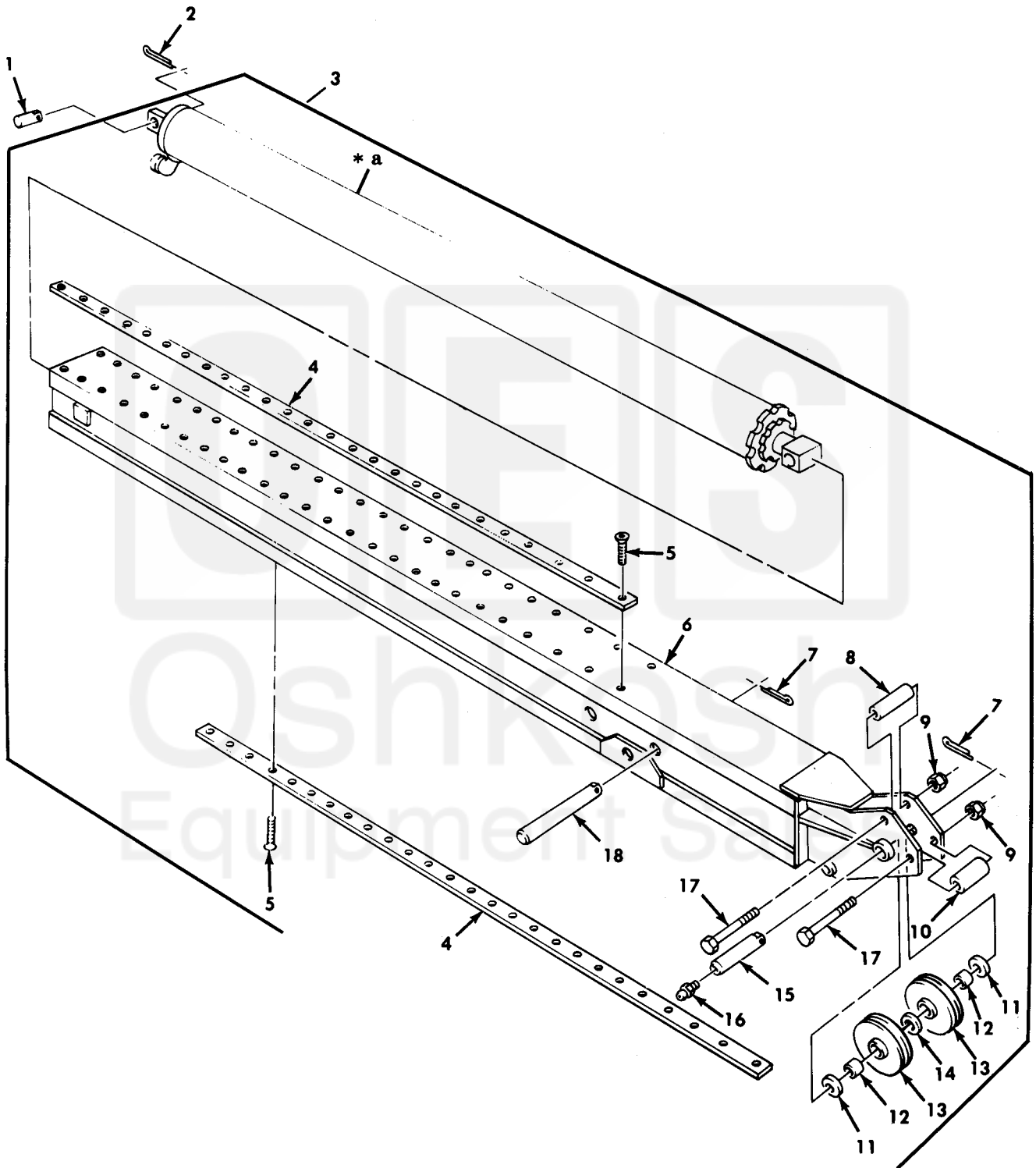

* a FOR BREAKDOWN SEE FIGURE 392

Figure 391. Wrecker Inner Boom Extension Assembly.

(1) ITEM NO	(2) SMR CODE	(3) NSN	(4) CAGEC	(5) PART NUMBER	(6) DESCRIPTION AND USABLE ON CODE (UOC)	(7) QTY
GROUP 2001 HOIST, CRANE, OR WINCH ASSEMBLY						
FIG. 391 WRECKER INNER BOOM EXTENSION ASSEMBLY						
1	PAFZZ	3040-00-143-6390	19207	10900203	SHAFT, STRAIGHT UOC: 622	1
2	PAFZZ	5315-00-013-7308	96906	MS24665-627	PIN, COTTER UOC: 622	1
3	PAFHH	2590-00-179-7053	19207	10876205	BOOM EXTENSION, MIDD UOC: 622	1
4	PAFZZ	2590-00-134-1121	19207	10899986	. TRACK, ROLLER BOOM UOC: 622	4
5	PAFZZ	5305-00-050-9221	96906	MS24667-41	. SCREW, CAP, SOCKET HE UOC: 622	104
6	PAFZZ	2590-00-086-7460	19207	10876182	. BOOM SECTION, INNER, UOC: 622	1
7	PAFZZ	5315-00-846-0126	96906	MS24665-628	. PIN, COTTER UOC: 622	2
8	PAFZZ	5365-00-177-9194	19207	10900247	. SPACER, SLEEVE UOC: 622	1
9	PAFZZ	5310-00-982-5012	96906	MS21045-12	. NUT, SELF-LOCKING, HE UOC: 622	2
10	PAFZZ	5365-00-413-4371	19207	11611656	. SPACER, SLEEVE UOC: 622	1
11	PAFZZ	3120-00-740-9729	19207	7409729	. BEARING, WASHER, THRU UOC: 622	2
12	PAFZZ	3120-00-509-8270	19207	7064597	. BUSHING, SLEEVE UOC: 622	2
13	PAFZZ	3020-00-446-8616	19207	10876383	. PULLEY, GROOVE UOC: 622	2
14	PAFZZ	5310-00-984-8818	96906	MS27183-32	. WASHER, FLAT UOC: 622	1
15	PAFZZ	5315-00-244-1340	19207	10899989	. PIN, STRAIGHT, HEADLE UOC: 622	1
16	PAOZZ	4730-00-172-0034	96906	MS15003-6	. FITTING, LUBRICATION UOC: 622	2
17	PAFZZ	5305-00-928-9636	96906	MS90727-199	. SCREW, CAP, HEXAGON H UOC: 622	2
18	PAFZZ	5315-00-446-8740	19207	10899976	. PIN, STRAIGHT, HEADLE UOC: 622	1

END OF FIGURE