

FIELD AND SUSTAINMENT MAINTENANCE
REPAIR PARTS AND SPECIAL TOOLS LIST

TRUCK, CARGO: 2-1/2-TON, 6X6, M44A2 SERIES TRUCKS (MULTIFUEL)

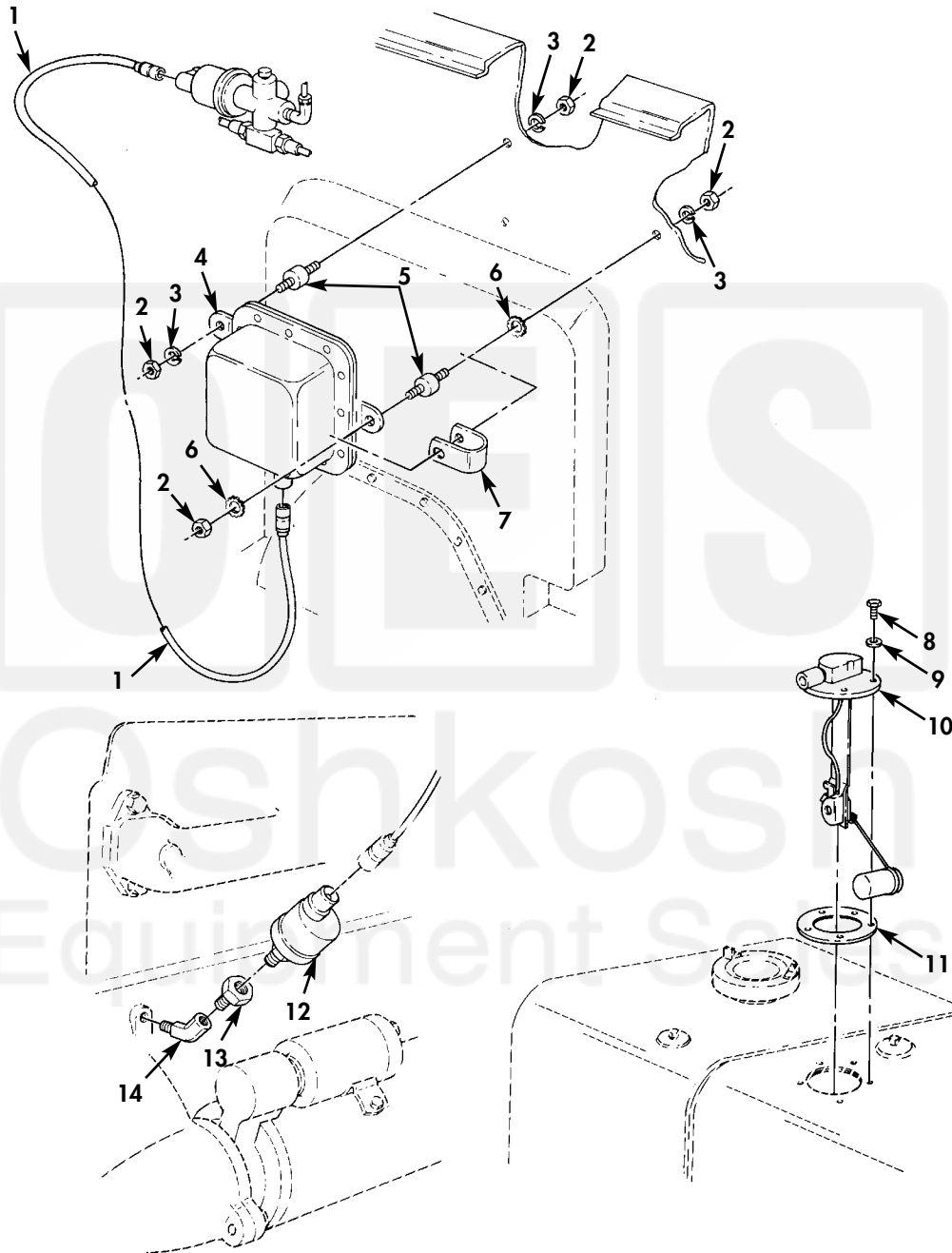

Figure 46. Sending Units and Warning Switches.

| (1) ITEM NO | (2) SMR CODE | (3) NSN | (4) CAGEC | (5) PART NUMBER | (6) DESCRIPTION AND USABLE ON CODE (UOC) | (7) QTY |
|---|--------------------|------------------|--------------|-----------------------|---|------------|
| GROUP 0610 SENDING UNITS AND WARNING SWITCHES | | | | | | |
| FIG. 46 SENDING UNITS AND WARNING SWITCHES | | | | | | |
| 1 | PAOZZ | 5995-00-862-2669 | 19207 | 10871548 | LEAD,ELECTRICAL..... | 1 |
| 2 | PAOZZ | 5310-00-768-0319 | 96906 | MS51968-2 | NUT,PLAIN,HEXAGON..... | 6 |
| 3 | PAOZZ | 5310-00-582-5965 | 80205 | MS35338-44 | WASHER,LOCK..... | 5 |
| 4 | PAOZZ | 6350-00-772-7664 | 19207 | 8675930 | BUZZER..... | 1 |
| 5 | PAOZZ | 5342-00-115-0552 | 19207 | 8741441-2 | MOUNT,BUZZER,WARNIN..... | 3 |
| 6 | PAOZZ | 5310-00-889-2528 | 96906 | MS45904-68 | WASHER,LOCK..... | 2 |
| 7 | PAOZZ | 6150-00-465-1633 | 19207 | 11609491 | BUS,CONDUCTOR..... | 1 |
| 8 | PAOZZ | 5305-00-984-6195 | 80205 | MS35206-247 | SCREW,MACHINE..... | 5 |
| 9 | PAOZZ | 5310-00-810-5335 | 80205 | MS15795-507 | WASHER,FLAT..... | 5 |
| 10 | PAOZZ | 6680-00-807-0863 | 96906 | MS500040-5 | TRANSMITTER,LIQUID..... | 1 |
| 11 | PAOZZ | 5330-00-753-9072 | 19207 | 7539072 | GASKET..... | 1 |
| 12 | PAOZZ | 6620-00-993-5546 | 96906 | MS24539 | TRANSMITTER,PRESSUR..... | 1 |
| 13 | PAOZZ | 6680-00-807-0863 | 72582 | 444000 | COUPLING, PIPE..... | 1 |
| 14 | PAOZZ | 4730-00-911-5707 | 7X677 | 454097 | ELBOW,PIPE..... | 1 |

END OF FIGURE

