

Current part is item (9) on diagram. Available at [www.oshkoshequipment.com](http://www.oshkoshequipment.com)

(1)	(2)	(3)	(4)	(5)	(6)	(7)	(8)
ILLUS.							QTY
(a)	(b)	SMR	NATIONAL	PART		DESCRIPTION	U/M
FIG.	ITEM	CODE	STOCK	NUMBER	FSCM		INC
NO.	NO.		NUMBER			USABLE ON CODE	IN
							UNIT
						1801-BODY, CAB, HOOD AND HULL ASSEMBLIES (CONT'D)	
134	9	PAOZZ	9390-00-737-3301	7373301	19207	RUBBER CHANNEL: GLASS REGULATOR RUBBER	EA 1
134	10	PAOZZ	2510-00-179-5708	10906350	19207	FILLER	EA 1
134	11	PAOZZ	2510-00-737-3296	7373296	19207	CHANNEL: CAB DOOR GLASS REGULATOR, LEFT	EA 1
134	11	PAOZZ	2540-00-737-3297	7373297	19207	CHANNEL: CAB DOOR REGULATOR, RIGHT	EA 1
134	12	PAOZZ	5305-00-145-0602	8743910	19207	SCREW, SELF-LOCKING	EA 1
134	13	PAOZZ	2540-00-737-3304	7975607	19207	HANDLE, WINDOW REGULATOR	EA 1
134	14	PAOZZ	5330-00-621-2565	7397852	19207	WASHER, SPACER, HANDLE	EA 1
134	15	PAOZZ	2540-00-562-0422	7529309	19207	FASTENER, REGULATOR	EA 2
134	16	PAOZZ	2540-00-693-0603	7373290	19207	REGULATOR, GLASS, RH (USED ON DOOR, NSN 2510-00-737-3294, ONLY)	EA 1
134	16	PAOZZ	2540-00-693-0602	7373289	19207	REGULATOR, GLASS, LH (USED ON DOOR, NSN 2510-00-737-3293, ONLY)	EA 1
134	17	PAOZZ	5305-00-531-0451	8743909	19207	SCREW, ASSEMBLED WASHER	EA 1
134	18	PAOZZ	2540-00-797-5609	7975609	19207	HANDLE ASSEMBLY, DOOR	EA 1
134	19	PAOZZ	5305-00-483-2339	8743908	19207	SCREW, MACHINE	EA 4
134	20	PAOZZ	2540-00-741-0715	7410715	19207	HANDLE, DOOR: OUTSIDE	EA 1
134	21	PAOZZ	5305-00-177-5312	420982	21450	SCREW, ASSEMBLED WASHER	EA 10
134	22	PAOZZ	2540-00-737-3277	7373277	19207	LOCK, CAB DOOR: REMOTE CONTROL, RIGHT (USED ON DOOR, NSN 2510-00- 737-3294, ONLY)	EA 1
134	22	PAOZZ	2540-00-737-3276	7373276	19207	LOCK, CAB DOOR: LEFT (USED ON DOOR, NSN 2510-00-737-3293, ONLY)	EA 1
134	23	PAOZZ	5305-00-696-5285	187992	21450	SCREW, ASSEMBLED WASHER	EA 2
134	24	PAOZZ	2540-00-754-0419	7540419	19207	WEDGE, DOOR, DOVETAIL: MAKE (USED ON VEHICLES THROUGH SERIAL NUMBER M15229)	EA 1
134	25	PAOZZ	5365-00-533-3409	7529300	19207	SHIM	EA 1
134	26	PAOZZ	5305-00-078-7021	8743911	19207	SCREW, MACHINE	EA 16
134	27	PAOZZ	5340-00-737-3285	7373285	19207	HINGE,BUTT: CAB DOOR, RIGHT (USED ON DOOR, NSN 2510-00-737-3294, ONLY) (COMPONENTS SAME AS HINGE, NSN 5340-00-737-3284)	EA 2
134	27	PAOZZ	5340-00-737-3284	7373284	19207	HINGE, BUTT: CAB DOOR, LEFT, W/PIN, (USED ON DOOR, NSN 2510-00-737-3293, ONLY)	EA 2
134	28	PAOZZ	5315-00-338-1621	7539131	19207	PIN, STRAIGHT	EA 1
134	29	PAOZZ		7529301	19207	LEAF	EA 1

Current part is item (9) on diagram. Available at [www.oshkoshequipment.com](http://www.oshkoshequipment.com)

TM 9-2320-209-34P

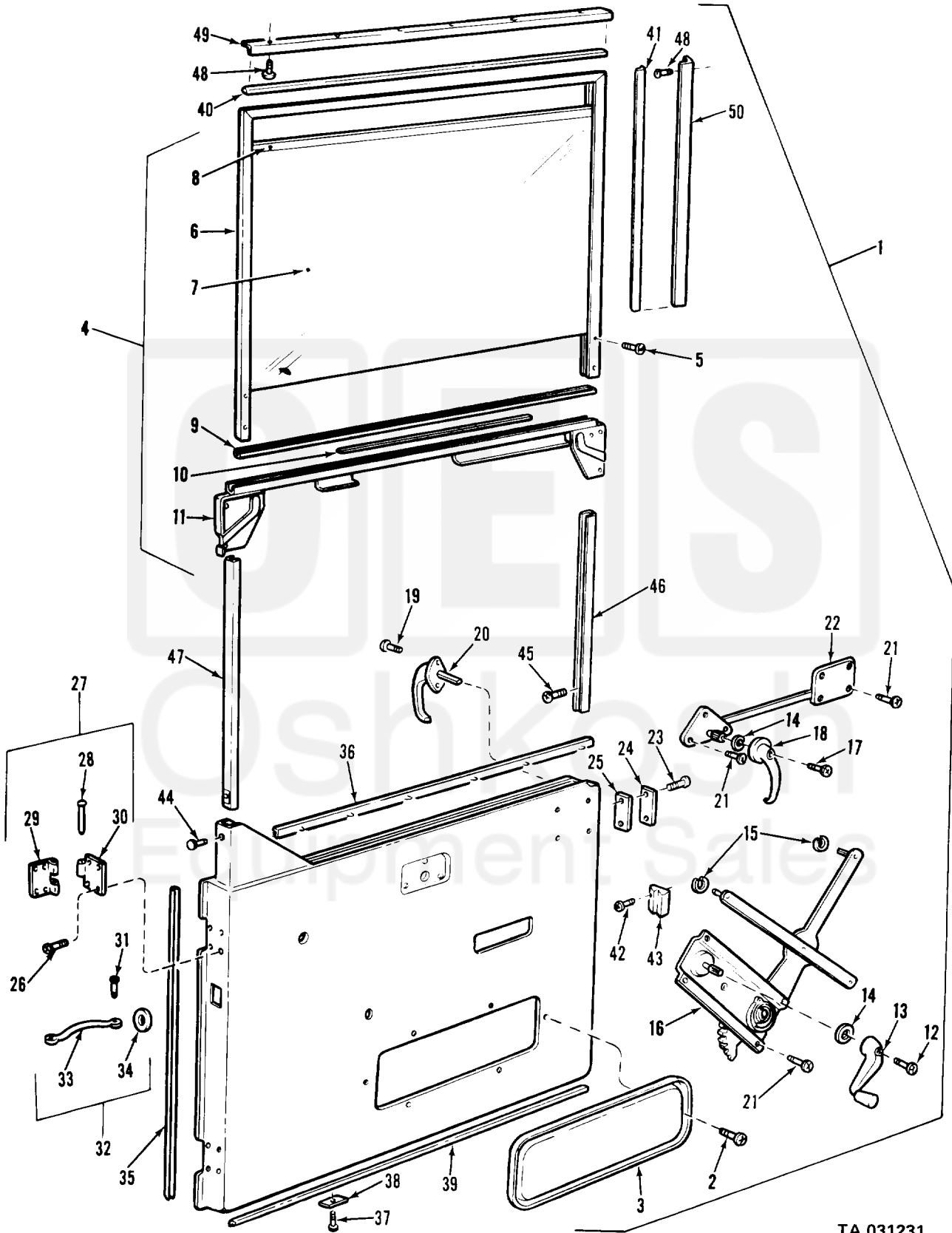

TA 031231

Figure 134. Cab door.