

(1)	(2)	(3)	(4)	(5)	(6)	(7)	(8)	(9)	(10)						
SMR	Federal	DESCRIPTION	UNIT	of	inc.	allowance	allowance	alw	maint						
Code	Stock	Number	meas	in				per	alw			(a)	(b)		
			Unit					100	per	equip	Figure	(a)	(b)		
								cnt-	equip	No.		No.	No.		
		Reference Number & Mfr. Code	Usable On Code	1-20	21-50	51-100	101-200	21-50	51-100	gcy					
		1801-BODY,CAB,HOOD AND HULL ASSEMBLIES-CONTINUED													
P-F	2510-650-10	FRAME,DOOR:RIGHT 7529305 (19207)	A	EA	2	*	*	*	*	*	*	3	5	130	21
P-F	2510-674-44	FRAME,DOOR:LEFT 7529304 (19207)	A	EA	2	*	*	*	*	*	*	3	5	130	21
P-F	2510-737-32	CHANNEL:RIGHT GLASS REGULATOR 7373297 (19207)	A	EA	1	*	*	*	*	*	*	4	10	130	22
P-F	2510-737-32	CHANNEL:CAB DOOR GLASS REGULATOR 7373296 (19207)	A	EA	1	*	*	*	*	*	*	4	10	130	22
X1		FILLER: 10906350 (19207)	A		2									130	23
P-F	2510-737-32	FRAME:DOOR GLASS 7373295 (19207)	A	EA	2	*	*	*	*	*	*	3	5	130	24
P-F	9320-737-33	CHANNEL,RUBBER:CABDOOR GLASS FRAME 7373300 (19207)	A	EA	2	*	*	*	*	*	*	4	10	130	25
P-F	5305-737-32	SCREW,TAPPING,THREAD:GLASS UPPER AND SIDE FRAME TO LOWER CHANNEL 7373275 (19207)	A	EA	8	*	*	*	*	*	*	6	10	130	26
P-F	9340-285-67	GLASS,SAFETY: 8635932 (19207)	A	EA	2	*	*	*	*	*	*	8	20	130	27
P-F	9320-737-33	CHANNEL,RUBBER:CAB DOOR GLASS REGULATOR 7373301 (19207)	A	EA	2	*	*	*	*	*	*	4	10	130	28
P-F	5305-015-70	SCREW,MACHINE: 157070 (70408)	A	EA	4	*	*	*	*	*	*	6	10	130	29
P-F	5310-582-87	WASHER,LOCK: MS35336-20 (96906)	A	EA	4	*	*	*	*	*	*	6	10	130	30
P-F	2540-741-07	HANDLE,DOOR:OUTSIDE 14892 (75198)	A	EA	2	*	*	*	*	*	*	4	10	130	31
P-F	2540-533-34	SHIM:DOOR,DOVETAIL 7529300 (19207)	A	EA	1	*	*	*	*	*	*	6	10	130	32
P-F	2540-754-04	WEDGE DOOR DOVETAIL: 7540419 (19207)	A	EA	2	*	*	*	*	*	*	4	10	130	33
P-F	5305-696-52	SCREW,ASSEMBLED WASHER: 187995 (24617)	A	EA	2	*	*	*	*	*	*	6	10	130	34
P-F	5305-531-03	SCREW,ASSEMBLED WASHER: DOOR LOCK 594270 (21450)	A	EA	20	*	*	*	*	*	*	6	20	130	35
P-F	2540-737-32	LOCK,DOOR,CAB:RIGHT 7373277 (19207)	A	EA	1	*	*	*	*	*	*	6	10	130	36

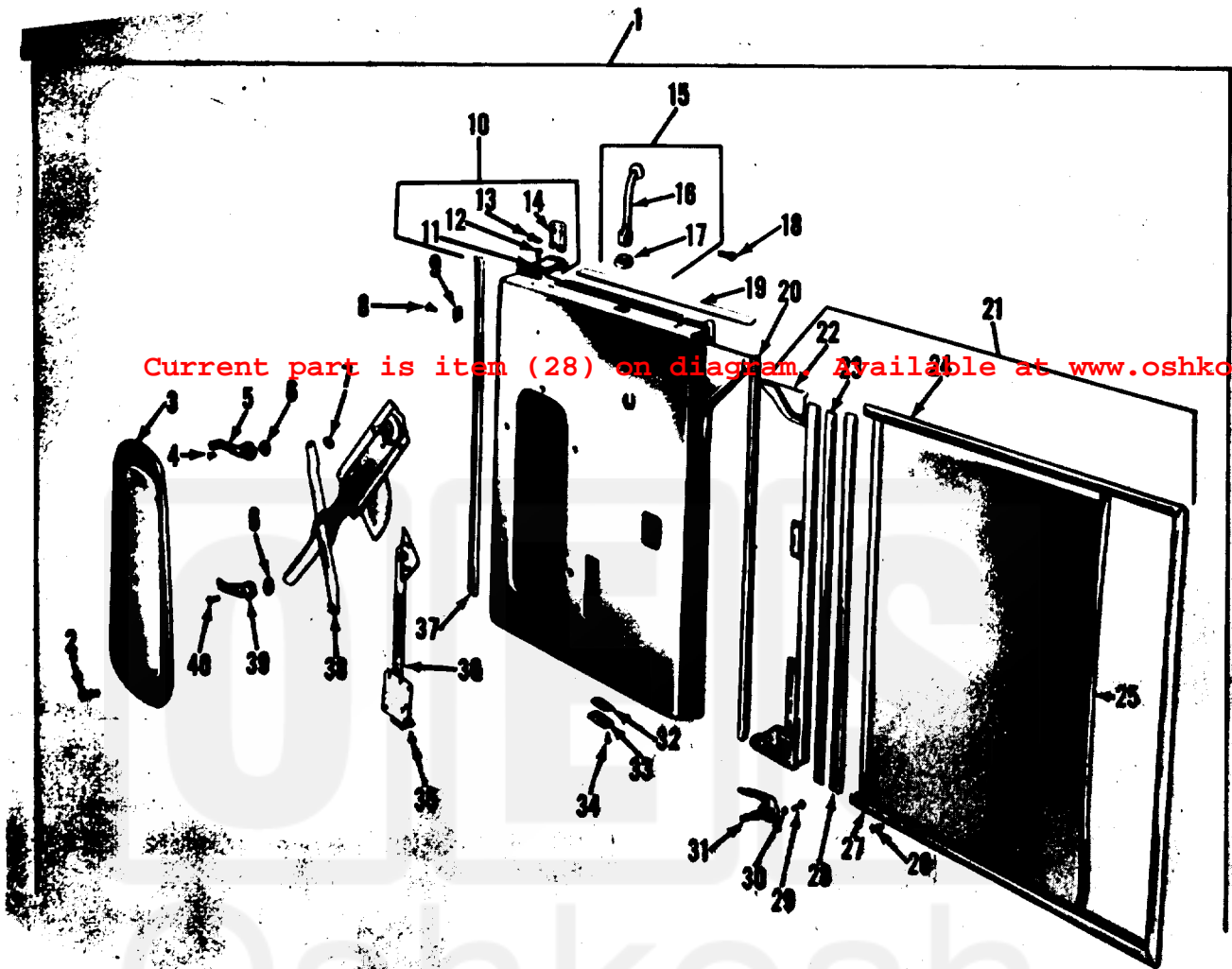

AT 47271

Figure 130. Cab door assembly.

Oshkosh
Equipment Sales