

(1) (2)
SMR Federal
Code Stock
Number

(3)
DESCRIPTION

TM9-2320-211-34P

(4) (5) (6)
Unit
of meas
in
Unit

(7)
allowance
allowance

(8) (9) (10)
alw
alw
alw

per
alw
100 per (a) (b)
equip100 Figure Item
cnt- equipNo. No.

Reference Number & Mfr. Code

Usable On Code

(a) (b) (c) (a) (b) (c)
1-20 21-5(51-10(1-20 21-5(51-10(gcy

2001-HOIST,WINCH,CRANE ASSEMBLY-CONTINUED

P-F	2520-923-42	COVER GEAR CASE: 7954476 (19207)	AD	EA	1	*	*	*	*	*	*	8	10	210	35
P-F	2520-741-34	COVER,END:GEAR CASE ASSEMBLY 7413441 (19207)	AD	EA	1	*	*	*	*	*	*	2	5	210	35
P-F	5305-958-52	SCREW,CAP,HEXAGON HEAD: END COVER MS35190-343 (96906)	AD	EA	4	*	*	*	*	*	*	6	10	210	36
P-F	5330-286-70	SEAL,PLAIN,ENCASED:DRUM SHAFT 500130 (21450)	AD	EA	1	*	*	*	*	*	*	10	100	210	37
P-F	5306-740-98	BOLT,MACHINE:END COVER 7409803 (19207)	AD	EA	4	*	*	*	*	*	*	6	10	210	38
P-F	5310-820-66	WASHER,LOCK:END COVER MS35338-50 (96906)	AD	EA	4	*	*	*	*	*	*	6	10	210	39
P-F	5315-281-76	KEY,MACHINE:WORM GEAR 8327444 (19207)	AD	EA	2	*	*	*	*	*	*	6	10	210	40
P-F	2520-740-97	WORM ASSEMBLY,WINCH: 7409730 (19207)	AD	EA	1	*	*	*	*	*	*	6	10	210	41
NON-ILLUSTRATED															
P-F	5315-209-79	PIN SHEAR:DRIVE FRONT WINCH 7409348 (19207)	AD	EA	1	*	*	*	*	*	*	6	10		
P-F	2520-740-98	BRACKET,ROLLER:RIGHT 7409805 (19207)	AD	EA	1	*	*	*	*	*	*	3	5	211	1
P-F	2590-740-97	WASHER,THRUST:DRUM ROLLER 7409729 (19207)	AD	EA	2	*	*	*	*	*	*	6	10	211	2
P-F	5310-741-70	WASHER,FLAT:CABLE DRUM BEARING 7417094 (19207)	AD	EA	2	*	*	*	*	*	*	10	40	211	3
P-F	2520-740-97	SHAFT,SHOULDER:ROLLER ASSEMBLY 7409725 (19207)	AD	EA	1	*	*	*	*	*	*	4	5	211	4
P-F	2520-740-96	ROLLER ASSEMBLY: 7409694 (19207)	AD	EA	1	*	*	*	*	*	*	4	5	211	5
X1		BEARING SLEEVE: 7409694 (19207)			4									211	6
P-F	2520-740-98	BRACKET,ROLLER:LEFT 7409804 (19207)	AD	EA	1	*	*	*	*	*	*	4	5	211	7
P-F	5305-725-01	SETSCREW:ROLLER BRACKET MS51963-137 (96906)	AD	EA	2	*	*	*	*	*	*	6	10	211	8
P-F	5310-740-97	WASHER,FLAT:SIDE ROLLER 7409728 (19207)	AD	EA	4	*	*	*	*	*	*	6	10	211	9

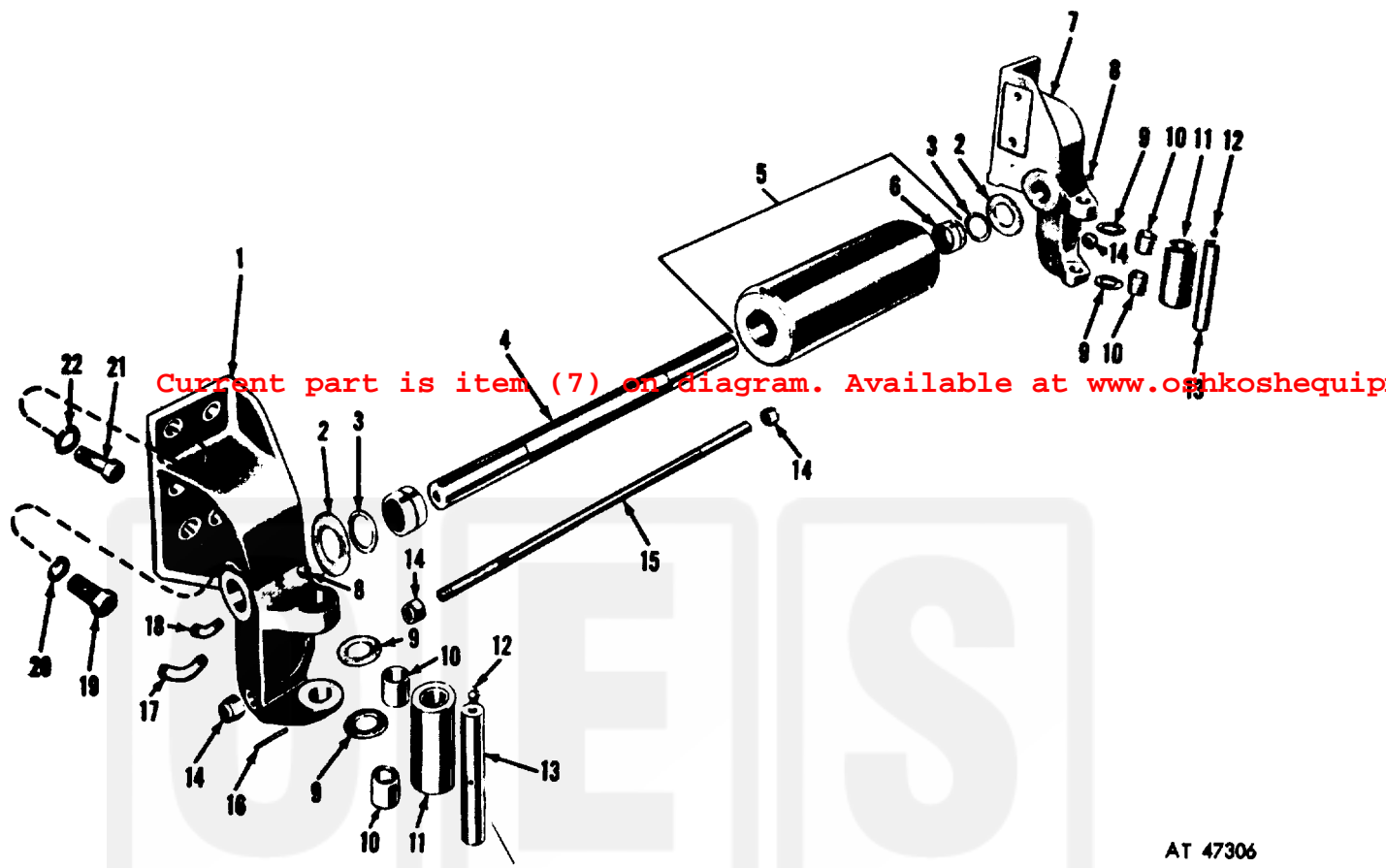

AT 47306

Figure 211. Roller assembly and related parts.

Oshkosh
Equipment Sales