

Figure 447. Transmission Power Takeoff Assembly and Mounting Hardware.

ITEM NO	SMR CODE	CAGEC	PART NUMBER	DESCRIPTION AND USABLE ON CODES(UOC)	QTY
GROUP 2004 POWER TAKEOFF ASSEMBLY					
FIG. 447 TRANSMISSION POWER TAKEOFF ASSEMBLY AND MOUNTING HARDWARE					
1	PAFFH	19207	7409589	POWER TAKEOFF,TRANS UOC:620,627,633	1
2	PAFZZ	24617	713421	BEARING UOC:620,627,633	1
3	PAFZZ	96906	MS35756-109	KEY,WOODRUFF UOC:620,627,633	1
4	PAFZZ	19207	7409594	SHAFT REVERSE GEAR UOC:620,627,633	1
5	XAFZZ	19207	10900574	SHAFT UOC:620,627,633	1
6	PAFZZ	19207	7373115	BEARING,SLEEVE UOC:620,627,633	1
7	PAFZZ	19207	7061281	WASHER,THRUST UOC:620,627,633	2
8	PAFZZ	96906	MS24665-281	PIN,COTTER UOC:620,627,633	1
9	PAFZZ	19207	7409587	GEAR REVERSE SHAFT UOC:620,627,633	1
10	PAFZZ	19207	8728251	PIN,STRAIGHT,HEADED UOC:620,627,633	1
11	PAFZZ	96906	MS90728-29	BOLT,MACHINE UOC:620,627,633	2
12	PAFZZ	81348	WW-P-471ACABCA	PLUG,PIPE UOC:620,627,633	1
13	PAFZZ	96906	MS17131-35	BEARING,ROLLER,NEED UOC:620,627,633	1
14	PAFZZ	95019	9P21	SHAFT,SHOULDERED UOC:620,627,633	1
15	PAFZZ	96906	MS24665-497	PIN,COTTER UOC:620,627,633	1
16	PAFZZ	19207	7538656	WASHER,KEY UOC:620,627,633	2
17	PAFZZ	19207	7538658	ROLLER ASSEMBLY,JOU UOC:620,627,633	2
18	PAFZZ	19207	7409586	GEAR CLUSTER UOC:620,627,633	1
19	PFFZZ	19207	7061160	HOUSING,POWER TAKEO UOC:620,627,633	1
20	PAFZZ	81348	111X03502K0000	BEARING,BALL,ANNULA UOC:620,627,633	1
21	PAFZZ	19207	7061265	SPACER POWER TAKE O UOC:620,627,633	1
22	PAFZZ	19207	5226140	RETAINER,SHIFTER SH UOC:620,627,633	1
23	PAFZZ	19207	8331558	SPRING,HELICAL,COMP UOC:620,627,633	1
24	PAFZZ	96906	MS19059-2422	BALL,BEARING	1

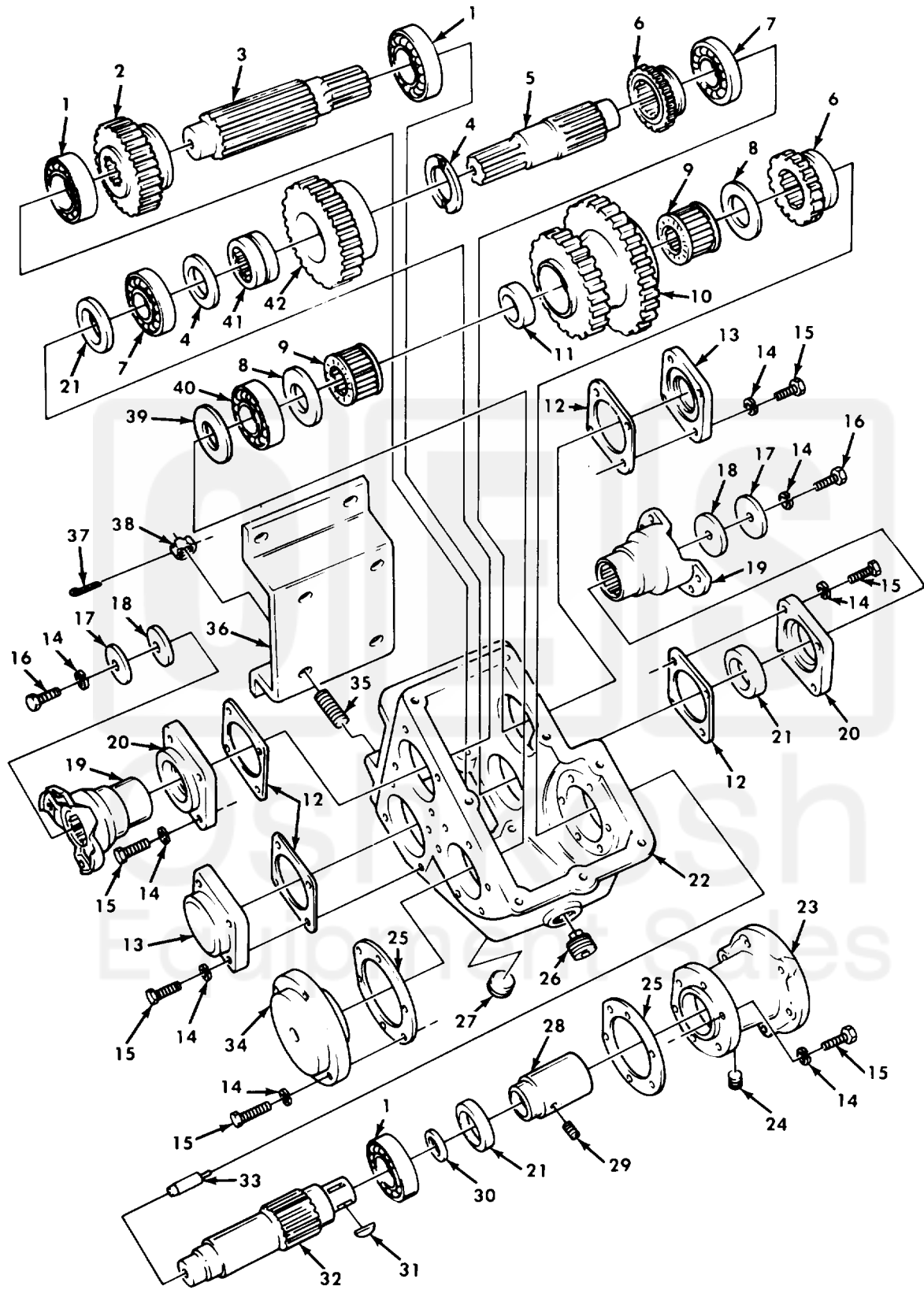

Figure 452. Power Divider Gears, Yokes, and Related Parts.

SECTION II TM9-2320-260-34P-2
 (1) (2) (3) (4) (5) (6)
 Current part is item (40,20) on diagram. Available at www.oshkoshequipment.com

ITEM NO	SMR CODE	CAGEC	PART NUMBER	DESCRIPTION AND USABLE ON CODES(UOC)	QTY
25	PAFZZ	19207	7414252	UOC:622 GASKET	2
26	PAOZZ	96906	MS49006-10	UOC:622 PLUG,PIPE,MAGNETIC	1
27	PAOZZ	21450	444673	UOC:622 PLUG,PIPE	1
28	PAFZZ	19207	7413947	UOC:622 COUPLING,SHAFT,RIGI	1
29	PAFZZ	96906	223088	UOC:622 SETScrew	1
30	PAFZZ	19207	8333868	UOC:622 SEAL,NONMETALLIC ST	1
31	PAFZZ	96906	MS35756-22	UOC:622 KEY,WOODRUFF	1
32	PAFZZ	19207	7414261	UOC:622 SHAFT,SHOULDERED	1
33	PAFZZ	19207	7414257	UOC:622 PIN,STRAIGHT,HEADLE	1
34	PAFZZ	19207	7413943	UOC:622 ADAPTER,GOVERNOR	1
35	PAFZZ	19207	10900283	UOC:622 STUD,PLAIN	4
36	PPFZZ	19207	10876386	UOC:622 BRACKETT,DOUBLE ANGL	1
37	PAFZZ	96906	MS24665-421	UOC:622 PIN,COTTER	4
38	PAFZZ	96906	MS35692-53	UOC:622 NUT,PLAIN,SLOTTED,H	4
39	PAFZZ	96906	MS51000-116-2	UOC:622 SEAL,PLAIN ENCASED	1
40	PAFZZ	81348	111X03502X0000	UOC:622 BEARING BALL,ANNULA	1
41	PAFZZ	96906	MS51961-28	UOC:622 BEARING,ROLLER,NEED	1
42	PAFZZ	19207	7414254	UOC:622 GEAR,SPUR	1

END OF FIGURE

Current part is item (40,20) on diagram. Available at www.oshkoshequipment.com