

TA 467936

Figure 225. Rear Wheel Hub and Drum Assembly.

Current part is item (12,19) on diagram. Available at www.oshkoshequipment.com

ILLUS. (a) FIG. NO.	(b) ITEM NO.	SMR CODE	NATIONAL STOCK NUMBER	PART NUMBER	FSCM	DESCRIPTION USABLE ON CODE	U/M	QTY INC IN UNIT
GROUP 1311 WHEEL ASSEMBLY								
FIG. 225 REAR WHEEL HUB AND DRUM ASSMEBLY								
225	1	PAOZZ	5310-00-353-2427	7979263	19207	NUT, PLAIN	EA	2
225	2	PAOZZ	5310-00-700-7089	5139123	19207	WASHER, KEY	EA	2
225	3	PAOZZ	5330-01-133-7262	5-X-633	78500	GASKET	EA	2
225	4	PAOZZ	5310-00-374-0836	7979308	19207	NUT, PLAIN	EA	2
225	5	XAOZZ		7979309	19207	NUT, PLAIN	EA	1
225	6	XAOZZ		7979310	19207	PIN, ADJUSTMENT	EA	1
225	7	PAOZZ	5330-00-961-3596	7413447	19207	SEAL, PLAIN	EA	2
225	8	PAOZZ	3110-00-100-4223	MS19081-181	96906	BEARING, ROLLER OUTER	EA	2
225	9	PAOZZ	5307-01-135-9290	20X-1527	78500	STUD, LEFT HAND THREAD UOC: DAV, V39	EA	20
225	9	PAOZZ	5307-01-135-9291	20X-1526	78500	STUD, RIGHT HAND THREAD UOC: DAV, V39	EA	20
225	9	PAOZZ	5307-01-132-8273	20X-1337X	78500	STUD, LEFT HAND THREAD UOC: DAA, DAB, DAC, DAD, DAE, DAF, DAG, DAH, DAJ, DAK, DAL, DAQ, DAR, DAW, DAX, V06, V07, V12, V13, V14, V15, V16, V17, V18, 19, V20, V21, V22, V24, V25	EA	20
225	9	PAOZZ	5307-01-132-8274	20X-1336	78500	STUD, RIGHT HAND THREAD UOC: DAA, DAB, DAC, DAD, DAE, DAF, DAG, DAH, DAJ, DAK, DAL, DAQ, DAR, DAW, DAX, V06, V07, V12, V13, V14, V15, V16, V17, V18, V19, V20, V21, V22, V24, V25	EA	20
225	10	PAOZZ	2530-01-134-6570	3219-C-4345	78500	DRUM	EA	2
225	11	PAOZZ	3040-01-134-1184	333-U-801	78500	HUB	EA	2
225	12	PAOZZ	2530-00-740-9553	7409553	19207	RING, WIPER	EA	2
225	13	PAOZZ	5330-00-740-9550	7979349	19207	SEAL, PLAIN, ENCASED	EA	2
225	14	PAOZZ	3110-00-100-4220	MS19081-182	96906	BEARING, ROLLER INNER	EA	2
225	15	PAOZZ	5310-00-176-6525	10938444-1	19207	NUT, PLAIN, SINGLE WHEEL STUD LEFT UOC: V06, V07, V12, V13, V14, V15, V16, V17, V18, V19, V20, V21, V22, V24, V25, V39	EA	20
225	15	PAOZZ	5310-00-176-6521	10938444-2	19207	NUT, PLAIN, SINGLE WHEEL STUD RIGHT UOC: V06, V07, V12, V13, V14, V15, V16, V17, V18, V19, V20, V21, V22, V24, V25, V39	EA	20
225	15	PAOZZ	5310-00-480-7606	109384443-2	19207	NUT, PLAIN, SINGLE WHEEL STUD RIGHT UOC: DAA, DAB, DAC, DAD, DAE, DAF, DAG, DAH, DAJ, DAK, DAL, DAQ, DAR, DAV, DAW, DAX	EA	20
225	15	PAOZZ	5310-00-141-0447	10938443-1	19207	NUT, PLAIN, SINGLE WHEEL STUD LEFT UOC: DAA, DAB, DAC, DAD, DAE, DAF, DAG, DAH, DAJ, DAK, DAL, DAQ, DAR, DAV, DAW, DAX	EA	20
225	16	PAOZZ	2530-00-359-1162	MS53068-2	96906	NUT, CAP, DUAL WHEEL RIGHT	EA	20
225	16	PAOZZ	2530-00-693-1029	MS53068-1	96906	NUT, CAP, DUAL WHEEL LEFT	EA	20
225	17	PBOZZ	5365-01-132-2015	3280-A-1977	78500	SPACER UOC: DAV, V39	EA	2

END OF FIGURE

Oshkosh
Equipment Sales

Current part is item (12,19) on diagram. Available at www.oshkoshequipment.com

Section II.

TM 9-2320-272-34P-1

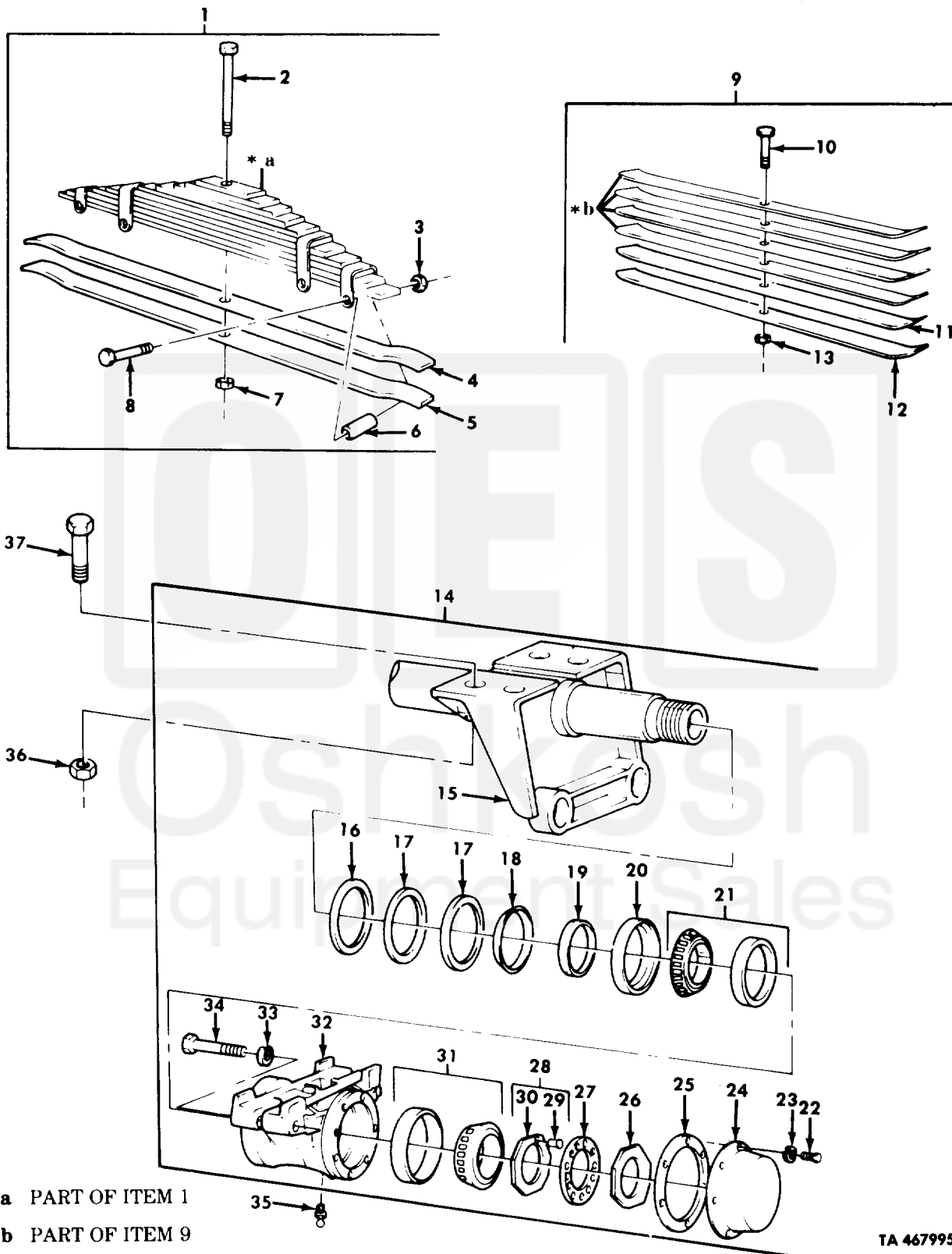

TA 467995

Figure 268. Rear Leaf Spring and Seat Assemblies.

Current part is item (12,19) on diagram. Available at www.oshkosequipment.com

ILLUS.		SMR CODE	NATIONAL STOCK NUMBER	PART NUMBER	FSCM	DESCRIPTION USABLE ON CODE	U/M	QTY
(a) FIG. NO.	(b) ITEM NO.							INC IN UNIT
GROUP 1601 SPRING								
FIG. 268 REAR LEAF SPRING AND SEAT ASSEMBLIES								
268	1	PAOOO	2510-00-741-1114	7411114	19207	SPRING ASSEMBLY UOC: DAV, V39	EA	2
268	1	PAOOO	2510-00-740-9613	7409613	19207	SPRING ASSEMBLY UOC: DAA, DAB, DAC, DAD, DAE, DAF, DAG, DAH, DAJ, DAK, DAL, DAQ, DAR, DAW, DAX, V06, V07, V12, V13, V14, V15, V16, V17, V18, V19, V20, V21, V22, V24, V25	EA	2
268	2	PAOZZ	5305-00-139-7075	10883199	19207	SCREW, MACHINE UOC: DAV, V39	EA	1
268	2	PAOZZ	5305-00-139-7072	10883200	19207	SCREW, MACHINE UOC: DAV, V39	EA	1
268	3	PAOZZ	5310-00-891-1711	MS35691-25	96906	NUT, PLAIN, HEXAGON	EA	4
268	4	PAOZZ	2510-00-741-1116	7411116	19207	SPRING, LEAF UOC: DAV, V39	EA	1
268	4	PAOZZ	2510-00-740-9602	7409602	19207	SPRING, LEAF UOC: DAV, V39	EA	1
268	5	PAOZZ	2510-00-741-1115	7411115	19207	SPRING, LEAF UOC: DAV, V39	EA	1
268	5	PAOZZ	2510-00-740-9601	7409601	19207	SPRING, LEAF UOC: DAV, V39	EA	1
268	6	PAOZZ	2510-00-740-9612	7409612	19207	SPACER	EA	4
268	7	PAOZZ	5310-00-732-0560	MS51968-14	96906	NUT, PLAIN, HEXAGON	EA	1
268	8	PAOZZ	5305-00-717-3999	MS90725-103	96906	SCREW, CAP, HEXAGON	EA	4
268	9	PAOOO	2510-00-277-9786	8327139	19207	SPRING ASSEMBLY UOC: DAL, V18	EA	2
268	10	PAOZZ	5306-00-446-8762	7017002	19207	BOLT, MACHINE UOC: DAL, V18	EA	1
268	11	PAOZZ	2510-00-318-0959	8327209	19207	SPRING, LEAF UOC: DAL, V18	EA	1
268	12	PAOZZ	2510-00-318-0960	8327210	19207	SPRING, LEAF UOC: DAL, V18	EA	1
268	13	PAOZZ	5310-00-943-2141	MS51968-15	96906	NUT, PLAIN, HEXAGON UOC: DAL, V18	EA	1
268	14	PAOOO	2510-00-191-8172	7346962	19207	SEAT ASSEMBLY	EA	1
268	15	PFOZZ	2510-00-740-9607	7409607	19207	TUBE ASSEMBLY	EA	1
268	16	PAOZZ	5310-00-740-9615	7979265	19207	WASHER, FLAT	EA	2
268	17	PAOZZ	5330-00-740-9312	5X625	78500	SPACER, RING	EA	4
268	18	PAOZZ	5330-00-740-9606	7409606	19207	RETAINER, PACKING	EA	2
268	19	PAOZZ	2530-00-740-9553	7409553	19207	RING, WIPER	EA	2
268	20	PAOZZ	5330-00-740-9550	7979349	19207	SEAL, PLAIN, ENCASED	EA	2
268	21	PAOZZ	3110-00-100-4223	MS19081-181	96906	BEARING, ROLLER	EA	1
268	22	PAOZZ	5306-00-225-8496	MS90725-31	96906	BOLT, MACHINE	EA	12
268	23	PAOZZ	5310-00-407-9566	MS35338-45	96906	WASHER, LOCK	EA	12
268	24	PAOZZ	2510-00-740-9391	7979306	19207	COVER, ACCESS	EA	2
268	25	PAOZZ	5330-00-740-9600	7979274	19207	GASKET	EA	2
268	26	PAOZZ	5310-00-353-2427	7979263	19207	NUT, PLAIN	EA	2
268	27	PAOZZ	5310-00-700-7089	5139123	19207	WASHER, KEY	EA	2
268	28	PAOZZ	5310-00-374-0836	7979308	19207	NUT, PLAIN	EA	2

Current part is item (12,19) on diagram. Available at www.oshkosequipment.com