

Current part is item (20) on diagram. Available at www.oshkoshequipment.com

(1) (a) FIG. NO.	(2) (b) ITEM NO.	(3) SMR CODE	(4) NATIONAL STOCK NUMBER	(5) PART NUMBER	(6) FSCM	(6) DESCRIPTION	(7) U/M	(8) INC IN UNIT
1100-REAR AXLE ASSEMBLY (CONT'D)								
110	19	PAOZZ	5310-00-880-2005	MS51983-4	96906	NUT,SINGLE BALL SEAT,HEXAGON: RIGHT,WHEEL STUD,OUTER (USED ON HUB AND ASSEMBLY, NSN 2530-00-134-5122, ONLY)	EA	6
110	20	PAOZZ	2530-00-693-1029	MS53068-1	96906	NUT,CAP:DUAL WHEEL,LEFT, WHEEL HUB STUD (USED ON HUB AND DRUM ASSEMBLY, NSN 2530-00-134- 5110, ONLY)	EA	6
110	20	PAOZZ	2530-00-359-1162	MS53068-2	96906	NUT,CAP:DUAL WHEEL,RIGHT, WHEEL HUB STUD (USED ON HUB AND DRUM ASSEMBLY, NSN 2530-00-134- 5122, ONLY)	EA	6
110	21	PAOZZ	5306-00-206-6339	10896719-1	19207	BOLT,RIBBED SHOULDER: HUB,LEFT (USED ON HUB AND DRUM ASSEMBLY, NSN 2530-00-134-5122, ONLY)	EA	6
110	21	PAOZZ	5306-00-206-6339	10896719-1	19207	BOLT,RIBBED SHOULDER: HUB,LEFT (USED ON HUB AND DRUM ASSEMBLY, NSN 2530-00-134-5110,ONLY)	EA	6
110	21	PAOZZ	5306-00-170-0141	10896719-2	19207	BOLT,RIBBED SHOULDER: HUB,RIGHT (USED ON HUB AND DRUM ASSEMBLY, NSN 2530-00-134-5122,ONLY)	EA	6
110	22	PAOZZ	2530-00-176-7859	10896708	19207	HUB	EA	1
110	23	PAOZZ	2530-00-288-2986	10896696	19207	BRAKE DRUM: SERVICE	EA	1
110	24	PAOZZ	3110-00-087-3930	10945151	19207	BEARING ASSEMBLY: HUB, INNER	EA	4
110	25	PAOZZ	5330-00-891-7826	10896684	19207	SEAL,PLAIN,ENCASED:HUB BEARING INNER	EA	4
110	31	PAOZZ	4820-00-726-4719	5196397	00000	VALVE,RELIEF	EA	2

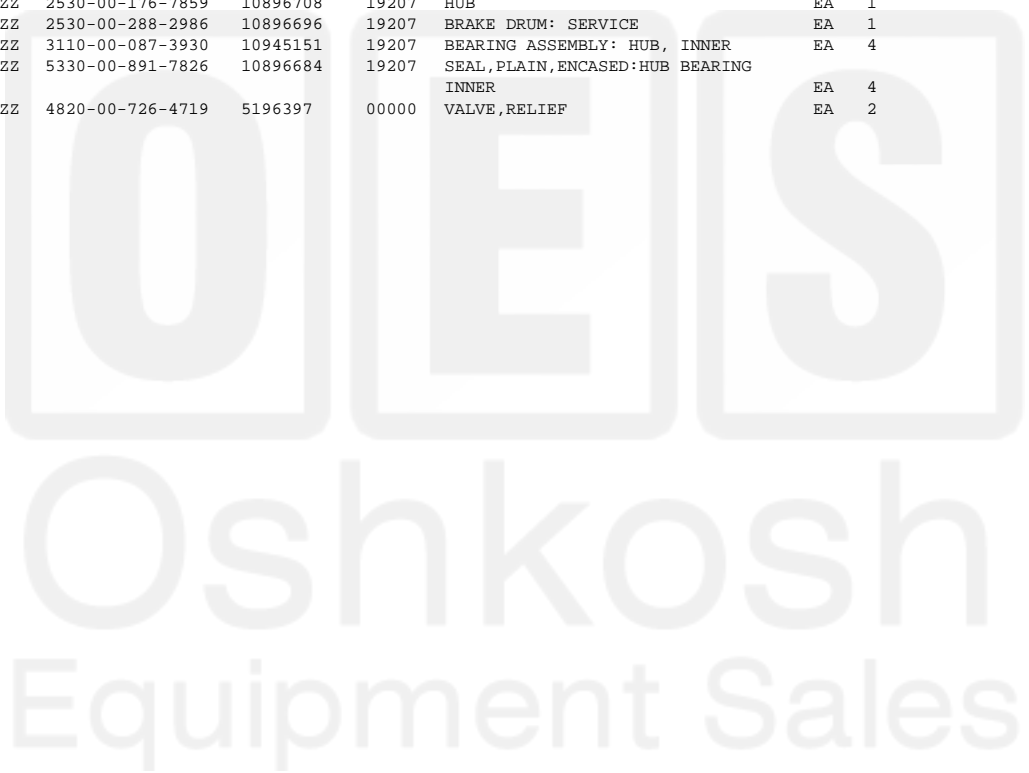

Current part is item (20) on diagram. Available at www.oshkoshequipment.com

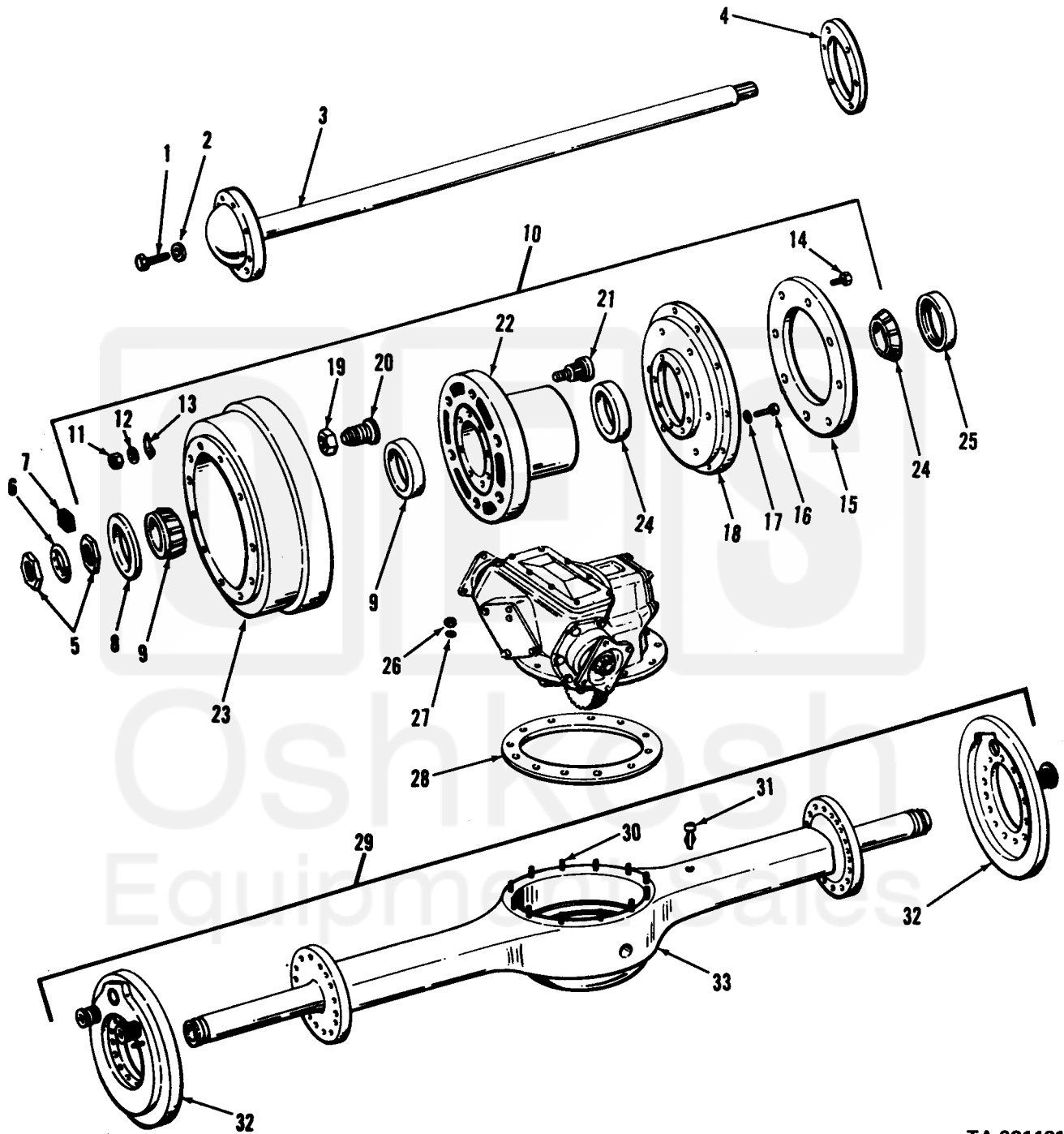

TA 031181

Figure 110. Rear hub, drum and axle shafts.