

(1) FIG. NO.	(2) ITEM NO.	(3) SMR CODE	(4) NATIONAL STOCK NUMBER	(5) PART NUMBER	(6) FSCM	(7) DESCRIPTION U/M	(8) INC IN UNIT
GROUP 11 - REAR AXLE							
1100 - REAR AXLE ASSEMBLY							
109	12	PAOZZ	5365-00-732-6126	7326126	19207	PLUG,MACHINE THREAD: FILLER	EA 1
109	13	PAOZZ	5330-00-514-3289	MS35769-21	96906	GASKET: FILLER PLUG	EA 1
109	14	PAOZZ	4730-00-240-9320	10896735	19207	PLUG,PIPE,MAGNETIC: DRAIN	EA 1
110	1	PAOZZ	5306-00-182-9267	10896726	19207	BOLT,MACHINE: BRAKE DRAIN ADAPTER	EA 32
110	2	PAOZZ	5310-00-584-5272	MS35338-48	96906	WASHER,LOCK: BRAKE DRAIN ADAPTER	EA 32
110	3	PAOZZ	2520-00-752-1730	7521730	19207	SHAFT,AXLE,AUTOMOTIVE: REAR	EA 2
110	4	PAOZZ	5330-00-599-4230	7521787	19207	GASKET: SHAFT	EA 4
110	5	PAOZZ	5310-00-220-2665	10896720	19207	NUT,PLAIN,OCTAGON:ADJUSTING BEARING	EA 8
110	6	PAOZZ	5310-00-752-1650	10896695	19207	WASHER,KEY: BEARING ADJUSTING NUT	EA 4
110	7	PAOZZ	5330-00-348-8365	8759693	19207	CORK: WHEEL BEARING LOCK KEYWAY	EA 4
110	8	PAOZZ	5330-00-706-1238	7061238	19207	SEAL,PLAIN,ENCASED: HUB BEARING, OUTER	EA 4
110	9	PAOZZ	3110-00-087-9881	10948079	19207	BEARING ASSEMBLY: HUB,OUTER	EA 4
110	10	PAOOO	2530-00-134-5110	8757681	19207	HUB AND DRUM ASSEMBLY: LEFT (COM- PONENTS SAME AS HUB AND DRUM ASSEMBLY, NSN 2530-00-134-5122, EXCEPT WHERE INDIVIDUAL COMPONENTS ARE ANNOTATED)	EA 2
110	10	PAOOO	2530-00-134-5122	8757682	19207	HUB AND DRUM ASSEMBLY: RIGHT	EA 2
110	11	PAOZZ	5310-00-732-0559	MS51968-8	96906	NUT,SELF-LOCKING	EA 10
110	12	PAOZZ	5310-00-637-9541	MS35338-46	96906	WASHER,LOCK	EA 10
110	13	PAOZZ	2530-00-134-5121	10896733	19207	COVER,INSPECTION: SERVICE BRAKE DRUM	EA 1
110	14	PAOZZ	5306-00-177-5278	10896689	19207	BOLT,RUBBED SHOULDER: SERVICE BRAKE	EA 10
110	15	PAOZZ	2530-00-134-5109	10896706	19207	DEFLECTOR,DIRT AND LIQUID: BRAKE DRUM ADAPTER	EA 1
110	16	PAOZZ	5306-00-930-5248	10896726-1	19207	BOLT,MACHINE: BRAKE DRUM ADAPTER	EA 8
110	17	PAOZZ	5310-00-584-5272	MS35338-48	96906	WASHER,LOCK: BRAKE DRUM ADAPTER	EA 8
110	18	PAOZZ	2530-00-406-1466	8357992	19207	ADAPTER ASSEMBLY	EA 1
110	19	PAOZZ	5310-00-880-2004	MS51983-3	96906	NUT,SINGLE BALL SEAT,HEXAGON: LEFT,WHEEL STUD, OUTER (USED ON HUB AND DRUM ASSEMBLY, NSN 2530-00-134-5110, ONLY)	EA 6

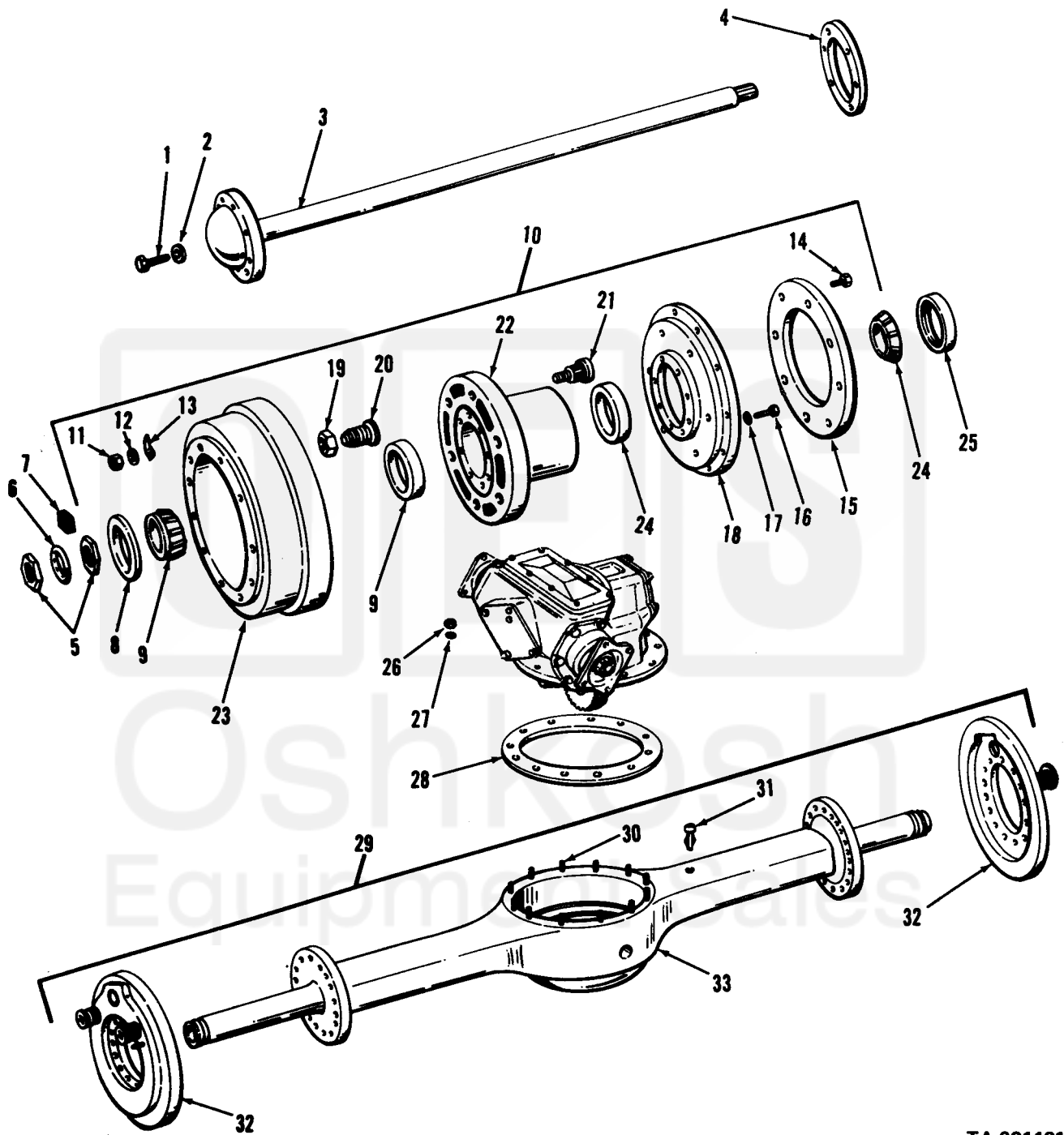



TA 031181

Figure 110. Rear hub, drum and axle shafts.