

Page 105. Figure 6-21 is superseded as follows:

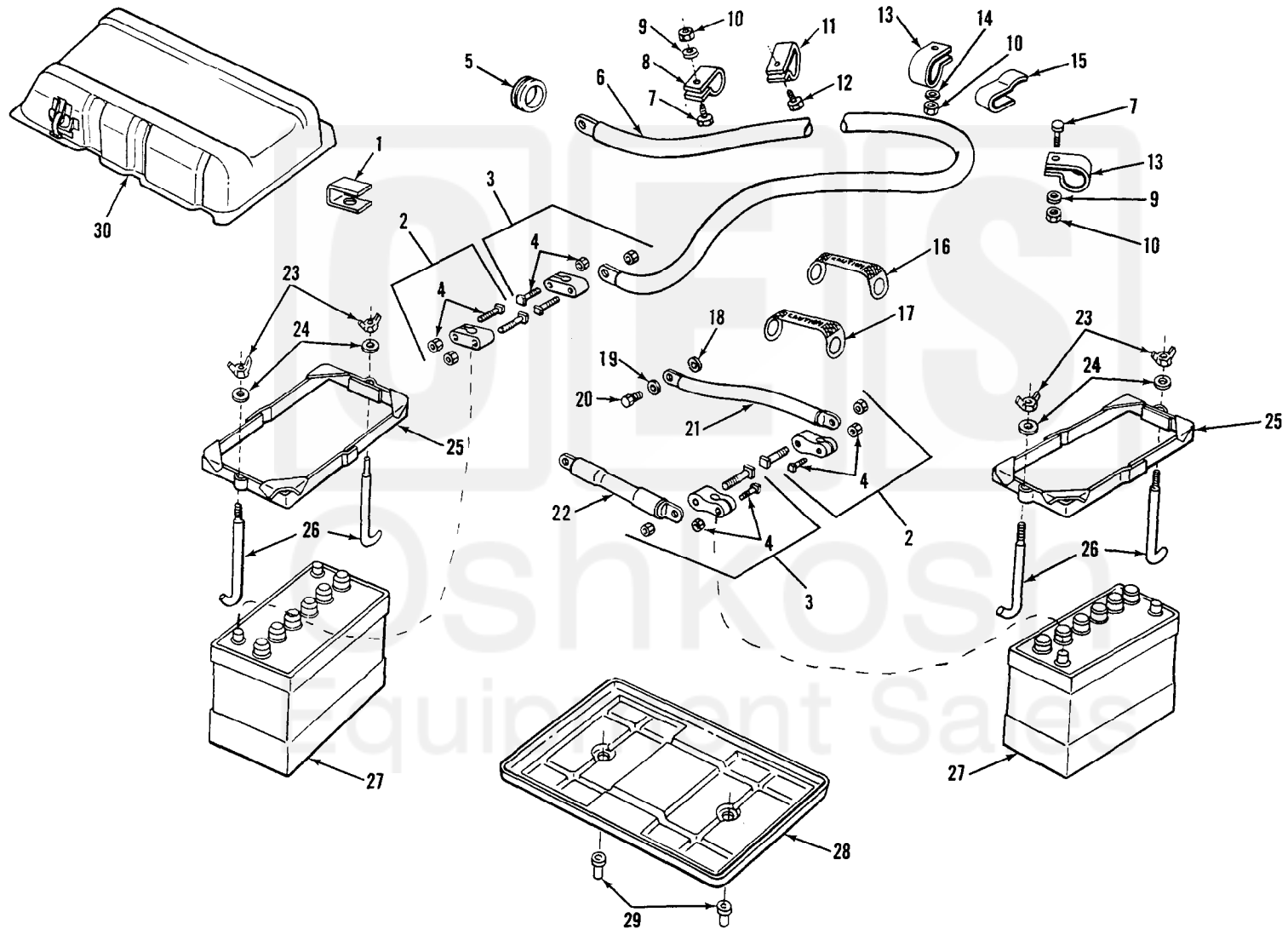

TA 010764

Figure 6-21. Batteries, cables and related parts.

(1) SMR CODE	(2) FEDERAL STOCK NUMBER	(3) DESCRIPTION  REFERENCE NUMBER & MFG. CODE      USABLE ON CODE		(4) UNIT OF MEAS.	(5) QTY INC IN UNIT	(6) 15-DAY ORGANIZATIONAL MAINTENANCE ALW				(7) ILLUSTRATION	
						(a) 1-5	(b) 6-20	(c) 21-50	(d) 51-100	(a) FIGURE NO.	(b) ITEM NO.
		GROUP 0612—BATTERIES, STORAGE (NON-ILLUSTRATED) BATTERIES, CABLES AND RELATED PARTS FIG. 6-21									
PO	2920-738-6272	COVER, BATTERY TERMINAL LUG: 10942521 (19207).		EA	4	*	*	*	*	6-21	1
PO	5940-549-6583	TERMINAL, LUG: clamp type, neg., with bolt and nut, for lug type cable terminal, MS75004-2 (96906).		EA	2	*	*	*	*	6-21	2
PO	5940-549-6581	TERMINAL, LUG: clamp type, pos., with bolt and nut, for lug type cable terminal, MS75004-1 (19207).		EA	2	*	*	*	*	6-21	3
PO	5306-058-3708	BOLT, MACHINE: with nut, battery terminal lug, 583708 (21450).		EA	4	*	*	*	*	6-21	4
PO	5325-098-3377	GROMMET: battery to starter switch cable, MS35490-19 (96906).		EA	1	*	*	*	*	6-21	5
MFO		CABLE ASSEMBLY: battery to starter switch, 11644871-4 (19207).		EA	1	*	*	*	*	6-21	6
PO	5305-988-1723	SCREW, MACHINE: pan head, cross-recessed, carb-s, cd-pltd, 1/4-20 UNC-2A X 1/2 in. lg, battery to starter switch cable clamp attaching, MS35206-279 (96906).		EA	2	*	*	*	*	6-21	7
PO	5340-880-7497	CLAMP, DOUBLE CABLE: to retain battery to starter switch and starter switch to starter cables; (optional) 7721422 (19207).		EA	1	*	*	*	*	6-21	8
PO	5310-550-1130	WASHER, LOCK: flat, internal tooth, carb-s, cd-pltd, for 1/4 screw size, battery to starter switch cable clamp attaching, MS35333-40 (96906).		EA	1	*	*	*	*	6-21	9
PO	5310-761-6882	NUT, PLAIN, HEXAGON: carb-s, cd-pltd, 1/4-20 UNC-2B, battery to starter switch cable clamp attaching, MS51967-2 (96906).		EA	3	*	*	*	*	6-21	10
PO	5340-926-5449	CLAMP, DOUBLE CABLE: battery to starter switch cable, MS21334-28 (96906).		EA	2	*	*	*	*	6-21	11
PO	5306-042-3545	SCREW AND WASHER ASSEMBLY: battery to starter switch cable clamp attaching, 423545 (24617).		EA	2	*	*	*	*	6-21	12
PO	5340-984-8540	CLAMP, CABLE: battery to starter switch cable, MS21333-102 (96906).		EA	2	*	*	*	*	6-21	13
PO	5310-582-5965	WASHER, LOCK: split, carb-s, cd-pltd, for 1/4 screw size, battery to starter switch cable clamp attaching, MS35338-44 (96906).		EA	1	*	*	*	*	6-21	14
PO	5340-168-7178	CLIP: battery to starter switch cable, 7331197 (19207).		EA	2	*	*	*	*	6-21	15
PO	7690-477-3714	LABEL, BATTERY CABLE LEAD POSITIVE: 11630582-1 (19207).		EA	1	*	*	*	*	6-21	16
PO	7690-477-3715	LABEL, BATTERY CABLE LEAD NEGATIVE: 11630582-2 (19207).		EA	1	*	*	*	*	6-21	17
PO	5310-889-2527	WASHER, LOCK: internal and external tooth, carb-s, cd-pltd, for 5/16 screw size, to attach battery to ground cable, MS45904-72 (96906).		EA	1	*	*	*	*	6-21	18
PO	5310-514-6674	WASHER, LOCK: flat, external tooth, carb-s, cd-pltd, for 5/16 screw size, to attach battery to ground cable, MS35335-34 (96906).		EA	1	*	*	*	*	6-21	19
PO	5306-225-9084	SCREW, CAP, HEXAGON HEAD: carb-s, cd-pltd, 5/16-24 UNF-2A x 1/2 in. lg, to attach battery to ground cable, MS90726-29 (96906).		EA	1	*	*	*	*	6-21	20
MFO		CABLE ASSEMBLY: battery to ground, 11644871-2 (19207).		EA	1	*	*	*	*	6-21	21