

UNIT, DIRECT SUPPORT, AND GENERAL SUPPORT MAINTENANCE  
REPAIR PARTS AND SPECIAL TOOLS LIST

EXTENDED SERVICE PROGRAM (ESP)

TRUCK, CARGO, 2-1/2-TON, 6X6, M44A3 SERIES TRUCKS (DIESEL)

M35A3, W/O WINCH (NSN 2320-01-383-2047); W/WINCH (NSN 2320-01-383-3850);  
M35A3C, W/O WINCH (NSN 2320-01-383-2050); W/WINCH (NSN 2320-01-383-2049);  
M36A3, W/O WINCH (NSN 2320-01-383-2048); W/WINCH (NSN 2320-01-383-2046).

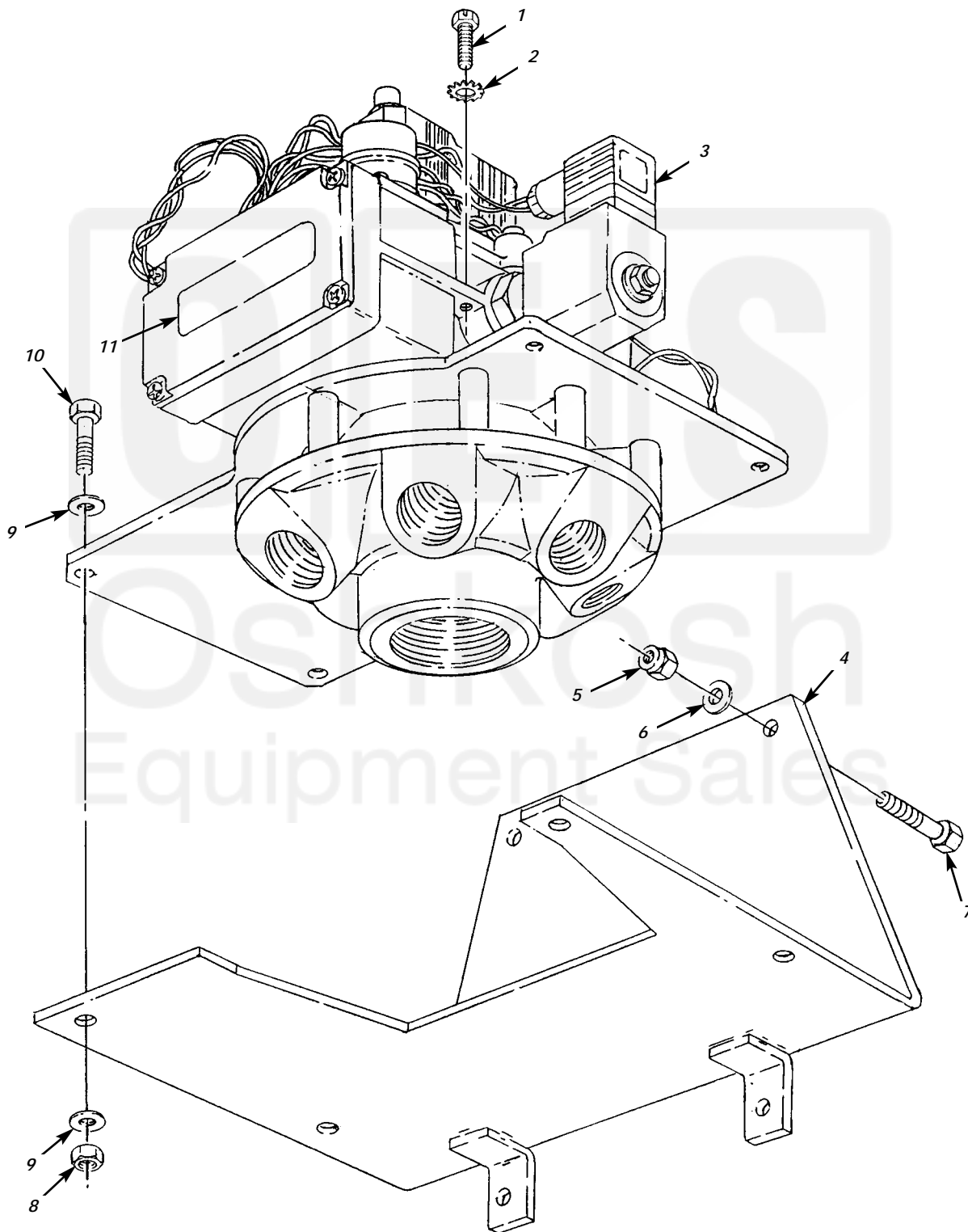
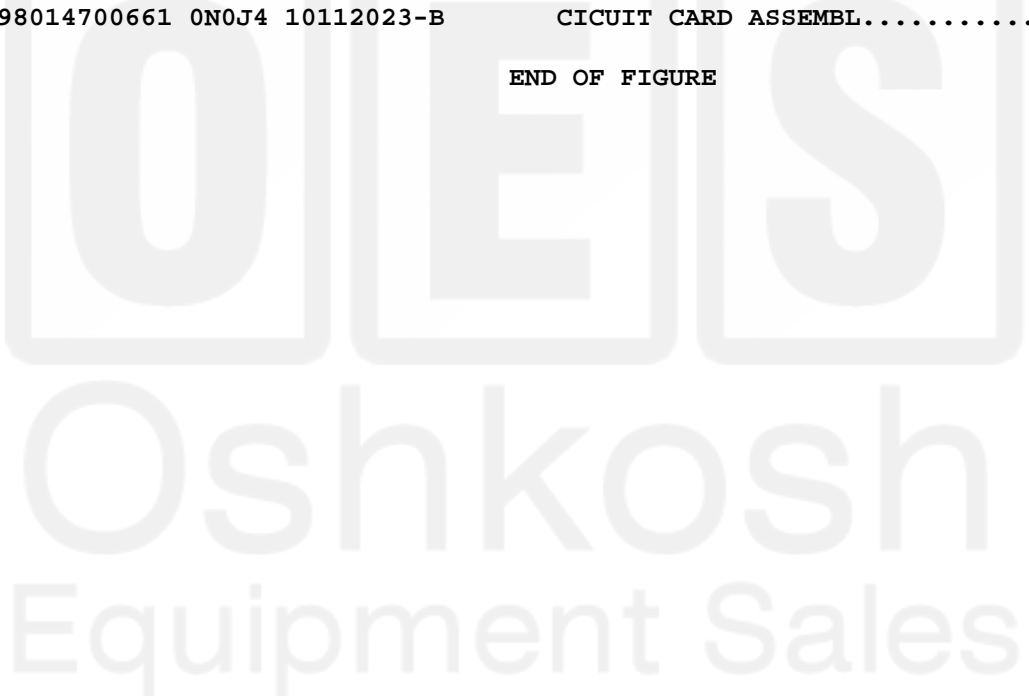

Figure 174. CTIS Manifold Assembly, Bracket, and Related Parts.

Current part is item (3) on diagram. Available at [www.oshkoshequipment.com](http://www.oshkoshequipment.com)

(1) ITEM NO	(2) SMR CODE	(3) NSN	TM9-2320-386-24P (4) CAGEC	(5) PART NUMBER	(6) DESCRIPTION AND USABLE ON CODES(UC)	0175 00 (7) QTY
GROUP 4317 MANIFOLD AND/OR CONTROL VALVES						
FIG. 174 CTIS MANIFOLD ASSEMBLY, BRACKET, AND RELATED PARTS						
1	PAZZ		24617	9416606	SCREW, MACHINE.....	1
2	PAZZ	5310002090788	96906	MS35335-30	WASHER, LOCK.....	1
3	PAZZ	4730014201021	19207	12448926	MANIFOLD ASSEMBLY, H POWER.....	1
4	PAZZ	5340014191330	34623	RCSK17509	BRACKET, ANGLE.....	1
5	PAZZ	5310009359021	96906	MS51943-35	NUT, SELF-LOCKING, HE.....	4
6	PAZZ	5310000806004	96906	MS27183-14	WASHER, FLAT.....	4
7	PAZZ	5305004182843	72582	454906	SCREW, CAP, HEXAGON H.....	4
8	PAZZ	5310000614650	96906	MS51943-31	NUT, SELF-LOCKING, HE.....	4
9	PAZZ	5310008094058	96906	MS27183-10	WASHER, FLAT.....	8
10	PAZZ	5305002253843	80204	B1821BH025C100N	SCREW, CAP, HEXAGON H.....	4
11	PAZZ	5998014700661	0N0J4	10112023-B	CICUIT CARD ASSEMBL.....	1

END OF FIGURE



Current part is item (3) on diagram. Available at [www.oshkoshequipment.com](http://www.oshkoshequipment.com)