

| (1)    | (2)  | (3)   | (4)              | (5)         | (6)   | (7)  | (8)   |
|--------|------|-------|------------------|-------------|-------|--|-------|
| ILLUS. |      |       |                  |             |       |  | QTY   |
| (a)    | (b)  | SMR   | NATIONAL         | PART        |       | DESCRIPTION  | U/M   |
| FIG.   | ITEM | CODE  | STOCK            | NUMBER      | FSCM  |  | INC   |
| NO.    | NO.  |       | NUMBER           |             |       | USABLE ON CODE   | IN    |
|        |      |       |                  |             |       |  | UNIT  |
|        |      |       |                  |             |       | 1801-BODY, CAB, HOOD, AND HULL ASSEMBLIES (CONT'D)   |       |
| 133    | 5    | PAFZZ | 5310-00-809-3078 | MS27183-11  | 96906 | WASHER, LOCK   | EA 42 |
| 133    | 6    | PAFZZ | 5305-00-068-0502 | MS90725-6   | 96906 | SCREW, CAP, HEXAGON HEAD   | EA 28 |
| 133    | 7    | XAFZZ |                  | 7085313     | 19207 | ROOF ASSEMBLY  | EA 1  |
| 133    | 8    | PAFZZ | 9390-00-040-1967 | 7085335     | 19207 | RUBBER, SPECIAL:<br>TOP WINDSHIELD FRAME   | EA 1  |
| 133    | 9    | PAFZZ | 5330-00-040-1968 | 7085352     | 19207 | SEAL, RUBBER, SPECIAL  | EA 2  |
| 133    | 10   | PBFZZ | 2510-00-087-3476 | 7085376     | 19207 | SASH ASSEMBLY  | EA 1  |
| 133    | 10   | PBFZZ | 2510-00-027-2075 | 7085377     | 19207 | SASH ASSEMBLY  | EA 1  |
| 133    | 11   | PAFZZ | 5310-00-934-9751 | MS35650-302 | 96906 | NUT  | EA 22 |
| 133    | 12   | PAFZZ | 5305-00-989-7434 | MS35207-263 | 96906 | SCREW, MACHINE   | EA 22 |
| 133    | 13   | PAFZZ | 5310-00-596-7691 | MS35335-32  | 96906 | WASHER, LOCK   | EA 22 |
| 133    | 14   | PAFZZ | 9390-00-040-1962 | 7085258     | 19207 | RUBBER, SPECIAL: REAR SIDES,<br>LEFT HAND, RUBBER  | EA 1  |
| 133    | 15   | PAFZZ | 2510-00-453-5351 | 7085257     | 19207 | RETAINER   | EA 4  |
| 133    | 16   | PAFZZ | 5305-00-052-6905 | MS24627-31  | 96906 | SCREW  | EA 2  |
| 133    | 17   | PAFZZ | 5310-00-493-3986 | 7085367     | 19207 | CLIP   | EA 2  |
| 133    | 18   | PAFZZ | 2540-00-878-3487 | 7085368     | 19207 | PANEL ASSEMBLY   | EA 1  |
| 133    | 19   | PBFZZ | 2510-00-753-9659 | 7539659     | 19207 | BRACKET: FRONT GUN MOUNT, OUTER  | EA 1  |
| 133    | 19.1 | PAOZZ | 5305-00-761-4227 | MS90726-111 | 96906 | BOLT   | EA 2  |
| 133    | 19.2 | PAOZZ | 5310-00-067-9507 | MS51922-37  | 96906 | NUT: SELF-LOCKING  | EA 2  |
| 133    | 19.3 | PAOZZ | 5306-00-042-5859 | 425859      | 21450 | BOLT   | EA 1  |
| 133    | 20   | PBFZZ | 2510-00-753-9659 | 7539659     | 19207 | BRACKET: REAR GUN MOUNT  | EA 2  |
| 133    | 21   | PBFZZ | 2510-00-418-0764 | 7539658     | 19207 | BRACKET: FRONT GUN MOUNT, INNER  | EA 1  |
| 13     | 1    | PAOOO | 1510-00-737-3294 | 7373294     | 19207 | DOOR: INCLUDES GLASS, HANDLES, LOCK<br>RIGHT, AND REGULATOR (COMPONENTS SAME<br>AS DOOR, NSN 2510-00-737-3293, EXCEPT<br>WHERE INDIVIDUAL COMPONENTS ARE<br>ANNOTATED) | EA 1  |
| 134    | 1    | PAOOO | 2510-00-737-3293 | 7373293     | 19207 | DOOR: LEFT INCLUDES GLASS<br>HANDLES, LOCK, AND REGULATOR  | EA 1  |
| 134    | 2    | PAOZZ | 5305-00-068-0506 | MS90726-6   | 96906 | SCREW, CAP, HEXAGON HEAD   | EA 6  |
| 134    | 3    | PAOZZ | 2510-00-693-0604 | 7373299     | 19207 | COVER, PLATE, ACCESS   | EA 2  |
| 134    | 4    | PAOZZ | 2510-00-650-1015 | 7529305     | 19207 | FRAME, DOOR: RIGHT (COMPONENTS<br>SAME AS FRAME, NSN 2510-00-674-4487,<br>EXCEPT AS ANNOTATED)   | EA 1  |
| 134    | 4    | PAOZZ | 2510-00-674-4487 | 7529304     | 19207 | FRAME, DOOR LEFT   | EA 1  |
| 134    | 5    | PAOZZ | 5305-00-052-9955 | MS24619-22  | 96906 | SCREW, TAPPING, THREAD FORMING:<br>GLASS AND UPPER AND SIDE FRAME TO<br>LOWER CHANNEL  | EA 4  |
| 134    | 6    | PAOZZ | 2510-00-737-3295 | 7373295     | 19207 | FRAME: DOOR GLASS WELDED   | EA 1  |
| 134    | 7    | PAOZZ | 5620-00-621-2561 | 7529307     | 19207 | SAFETY GLASS: DOOR GLASS   | EA 1  |
| 134    | 8    | PAOZZ | 9390-00-737-3300 | 7373300     | 19207 | RUBBER CHANNEL: CAB DOOR<br>GLASS FRAME RUBBER   | EA 1  |

TM 9-2320-209-34P

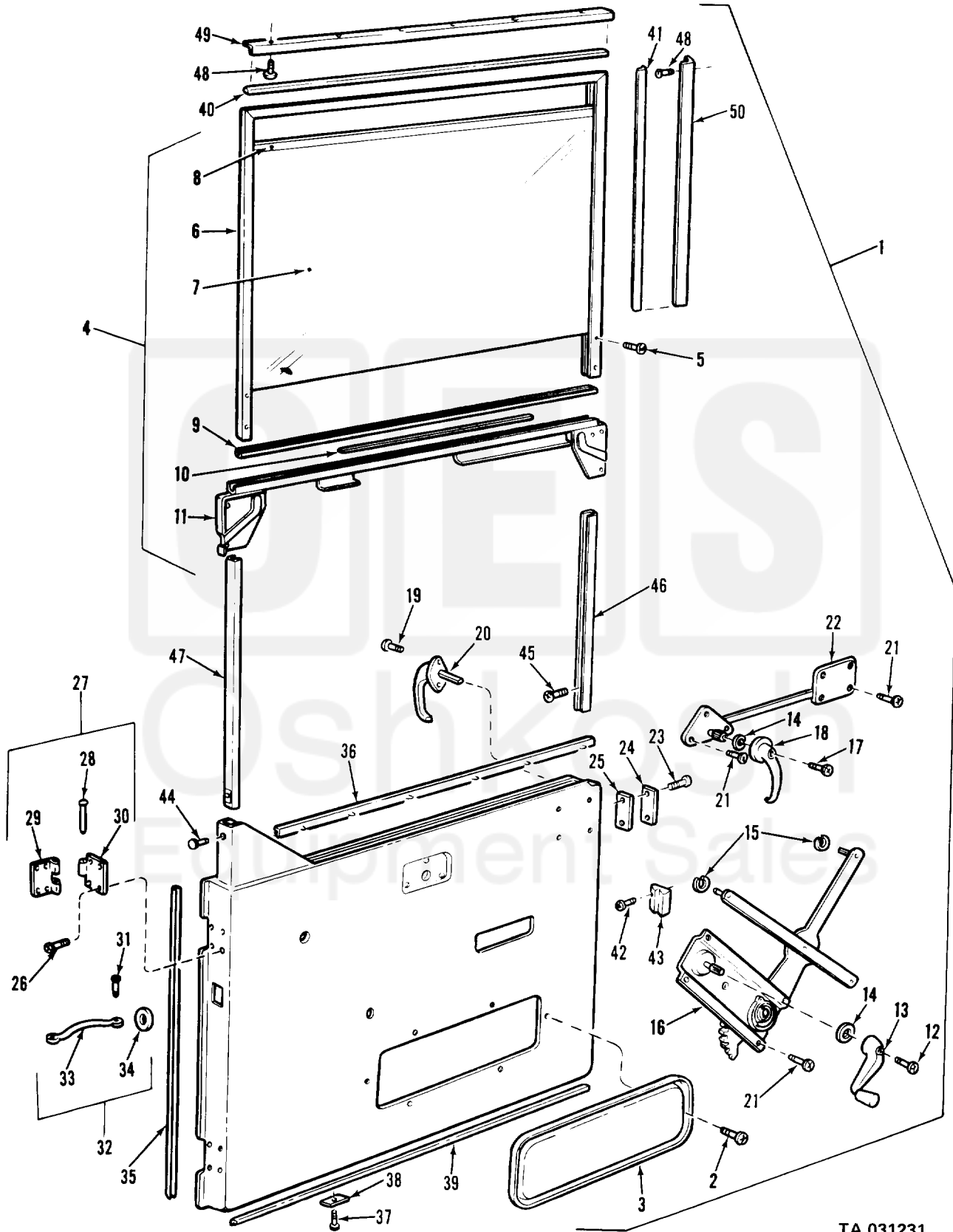

TA 031231

Figure 134. Cab door.

306 Change 1