

(1) (2)  
SMR Federal  
Code Stock  
Number

(3)  
DESCRIPTION

TM9-2320-211-34P

(4) (5) (6)  
of inc. allowance  
meas in  
Unit

(7)  
allowance

(8) (9) (10)  
alw maint  
per alw

100 per (a) (b)  
equip100 Figure Item  
cnt- equipNo. No.

Reference Number & Mfr. Code

Usable On Code

(a) (b) (c) (a) (b) (c)  
1-20 21-5(51-10(1-20 21-5(51-10(gcy

X2-O	1601-SPRINGS-CONTINUED BRACKET: 7992548 (19207)	A	EA	2	*	*	*	*	*	*	*	123	3
P-O	5340-740-93 BUMPER, RUBBER: 7409335 (19207)	A	EA	2	*	*	*	*	*	*	*	123	4
P-O	5306-515-54 BOLT, U:FRONT SPRING 8741540 (19207)	A	EA	4	*	*	*	*	*	*	*	123	5
P-O	5306-840-24 BOLT, U:FRONT SPRING 8402424 (19207)	(EXCEPT BC, BE, BE, HB, IA, LA, MA)	EA	4	*	*	*	*	*	*	*	123	5
P-O	5310-062-49 NUT, PLAIN, HEXAGON: HANGER MS21045-8 (96906)	A	EA	2	*	*	*	*	*	*	*	123	6
P-O	2510-741-23 PIN, VEHICULAR LEAF: SPRING TO HANGER (2), UPPER SHACKLE (2), LOWER SHACKLE (2) 7412376 (19207)	A	EA	6	*	*	*	*	*	*	*	123	7
P-O	4730-050-42 FITTING, LUBRICATION: MS15003-1 (96906)	A	EA	6	*	*	*	*	*	*	*	123	8
P-O	5305-246-65 SCREW, CAP, HEXAGON: HANGER SPRING MS90726-120 (96906)	A	EA	2	*	*	*	*	*	*	*	123	9
P-O	2510-740-93 SHACKLE ASSEMBLY: 7409344 (19207)	A	EA	2	*	*	*	*	*	*	*	123	10
P-O	3120-770-29 BEARING, SLEEVE: SPRING EYE AND SHACKLE (4) 7702941 (19207)	A	EA	8	*	*	*	*	*	*	*	123	11
X2-O	SHACKLE: SPRING 1081273 (19207)	A	EA	2	*	*	*	*	*	*	*	123	12
P-O	2510-741-11 SPRING, ASSEMBLY, LEAF: 7411110 (19207)	BE, IA	EA	2	*	*	*	*	*	*	*	123	13
P-O	2510-385-79 SPRING ASSEMBLY, LEAF: 8402437 (19207)	LA, MA	EA	2	*	*	*	*	*	*	*	123	13
P-O	2510-740-93 SPRING ASSEMBLY, LEAF: 7409345 (19207)	A (EXCEPT BE)	EA	2	*	*	*	*	*	*	*	123	13
X2-O	SEAT: LOWER 7409342 (19207)	A	EA	2	*	*	*	*	*	*	*	123	14
P-O	2510-740-93 PLATE, CLAMP: LEFT SPRING 7409340 (19207)	A	EA	1	*	*	*	*	*	*	*	123	15
P-O	2510-740-93 PLATE, CLAMP: RIGHT SPRING 7409341 (19207)	A	EA	1	*	*	*	*	*	*	*	123	15
P-O	5310-275-82 NUT, PLAIN, HEXAGON: CLAMP PLATE A298551 (19207)	A	EA	8	*	*	*	*	*	*	*	123	16
P-O	5310-013-11 WASHER, LOCK: CLAMP PLATE MS35339-33 (96906)	A	EA	8	*	*	*	*	*	*	*	123	17

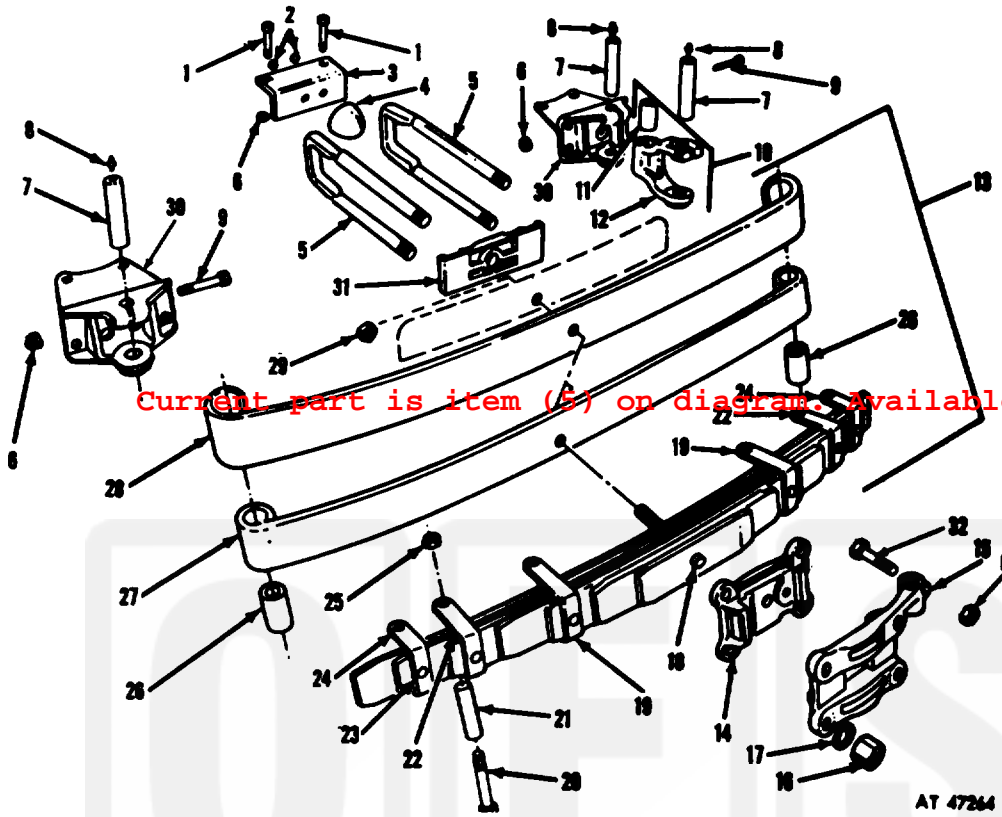

Figure 123. Front spring assembly and related parts.