

UNIT, DIRECT SUPPORT, AND GENERAL SUPPORT MAINTENANCE
REPAIR PARTS AND SPECIAL TOOLS LIST
TRUCK, 5-TON, 6X6, M809 SERIES TRUCKS (DIESEL)

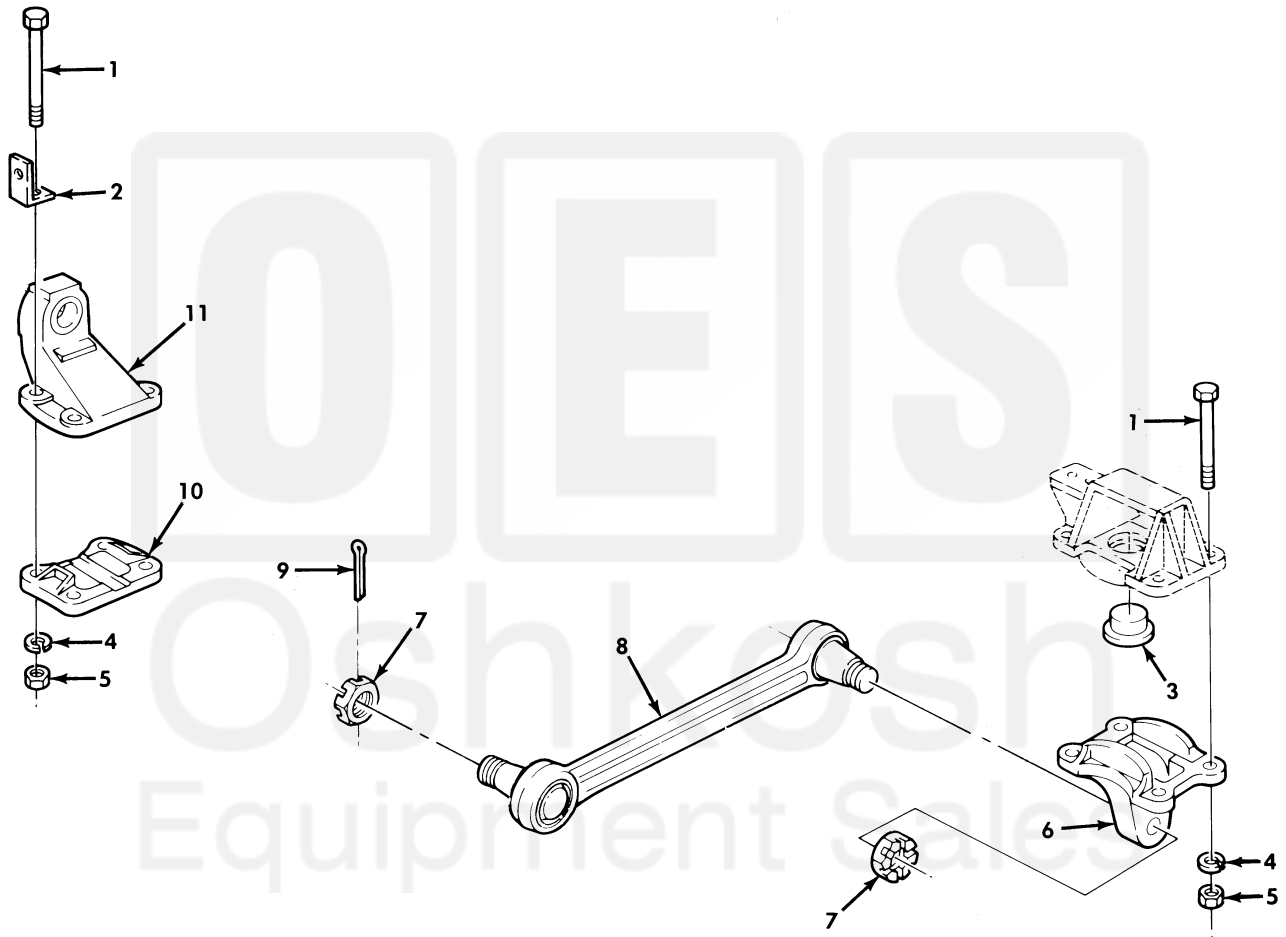

Figure 248. Torque Rods and Mounting Hardware.

(1) ITEM NO	(2) SMR CODE	(3) NSN	(4) CAGEC	(5) PART NUMBER	(6) DESCRIPTION AND USABLE ON CODE (UOC)	(7) QTY
GROUP 1605 TORQUE, RADIUS, AND STABILIZER RODS						
FIG. 248 TORQUE RODS AND MOUNTING HARDWARE						
1	PAOZZ	5306-00-272-3747	19207	7346956	BOLT, MACHINE.....	24
2	PAOZZ	5340-00-040-2271	19207	7409452	BRACKET, ANGLE.....	12
3	PAOZZ	2510-00-734-6952	19207	7979272	PLATE.....	4
4	PAOZZ	5310-00-754-2005	96906	MS35338-52	WASHER, LOCK.....	24
5	PAOZZ	5310-00-734-6957	19207	7979327	NUT, PLAIN, HEXAGON.....	24
6	PAOZZ	2530-00-797-9224	19207	7979224	BRACKET TORQUE ROD.....	4
7	PAOZZ	5310-00-740-9621	19207	7979183	.NUT, PLAIN, SLOTTED, H.....	2
8	PAOZA	2530-00-933-4941	19207	8728126	ROD, ALIGNING, VEHICU.....	6
UOC: 614, 622, 623, 624, 625, 626, 627, 628, 629, 630, 631, 632, 633, 634, 635, 637, 638						
8	PAOZZ	2530-00-235-4756	19207	8728128	TORQUE ROD, TANDEM A.....	6
UOC: 620, 621						
9	PAOZZ	5315-00-187-9567	96906	MS24665-500	PIN, COTTER.....	12
10	PAOZZ	3040-00-734-6953	19207	7346953	BRACKET, EYE, NONROTA.....	2
11	PAOZZ	5340-00-734-6954	19207	7346954	CLAMP, BRIDGE.....	2

END OF FIGURE

