

UNIT, DIRECT SUPPORT, AND GENERAL SUPPORT MAINTENANCE  
REPAIR PARTS AND SPECIAL TOOLS LIST  
TRUCK, 5-TON, 6X6, M809 SERIES TRUCKS (DIESEL)

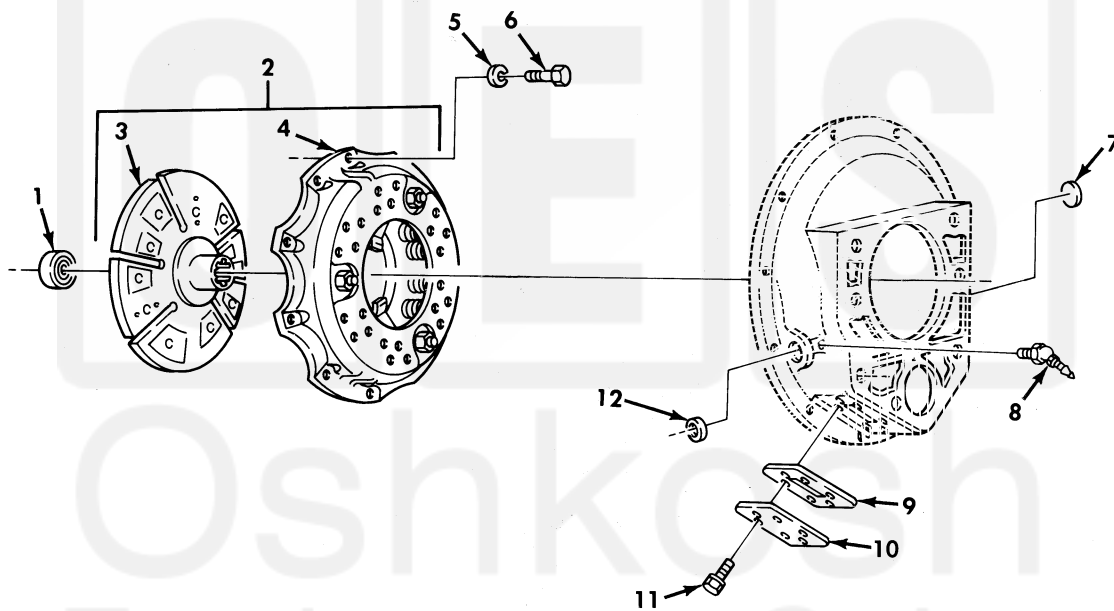

Figure 28. Clutch Assembly, Housing, and Related Parts.

(1) ITEM NO	(2) SMR CODE	(3) NSN	(4) CAGEC	(5) PART NUMBER	(6) DESCRIPTION AND USABLE ON CODE (UOC)	(7) QTY
GROUP 02 CLUTCH						
0200 CLUTCH RELEASE MECHANISM						
FIG. 28 CLUTCH ASSEMBLY, HOUSING, AND RELATED PARTS						
1	PAFZZ	3110-00-554-2975	24617	77506X1MILL3545	BEARING, BALL, ANNULA PART OF KIT P/N 5704526.....	1
2	XBFFF		19207	11664385	CLUTCH ASSEMBLY, FRI.....	1
3	PAFZZ	2520-00-107-0027	19207	11664387	.DISK, CLUTCH, VEHICUL PART OF KIT P/N 5704526.....	1
4	PAFZZ	2520-00-097-4152	19207	8735507	.CLUTCH ASSEMBLY, FRI PART OF KIT P/N 5704526.....	1
5	PAFZZ	5310-00-637-9541	96906	MS35338-46	WASHER, LOCK PART OF KIT P/N 5704526	12
6	PAFZZ	5305-00-068-0511	80204	B1821BH038C125N	SCREW, CAP, HEXAGON H PART OF KIT P/N 5704526.....	12
7	PAFZZ	5340-00-752-0976	19207	7520976	PLUG, EXPANSION.....	1
8	PAFZZ	4730-00-172-0028	96906	MS15003-4	FITTING, LUBRICATION.....	2
9	PAFZZ	5330-00-752-0957	19207	7520957	GASKET PART OF KIT P/N 8333711.....	1
10	PAFZZ	5340-00-752-0956	19207	7520956	COVER, ACCESS.....	1
11	PAFZZ	5306-00-043-1938	24617	431938	BOLT, ASSEMBLED WASH.....	6
12	PAFZZ	5330-01-046-7449	01212	450120	SEAL, PLAIN ENCASED.....	1

END OF FIGURE

