

SECTION II

EM 10-3930-243-34P

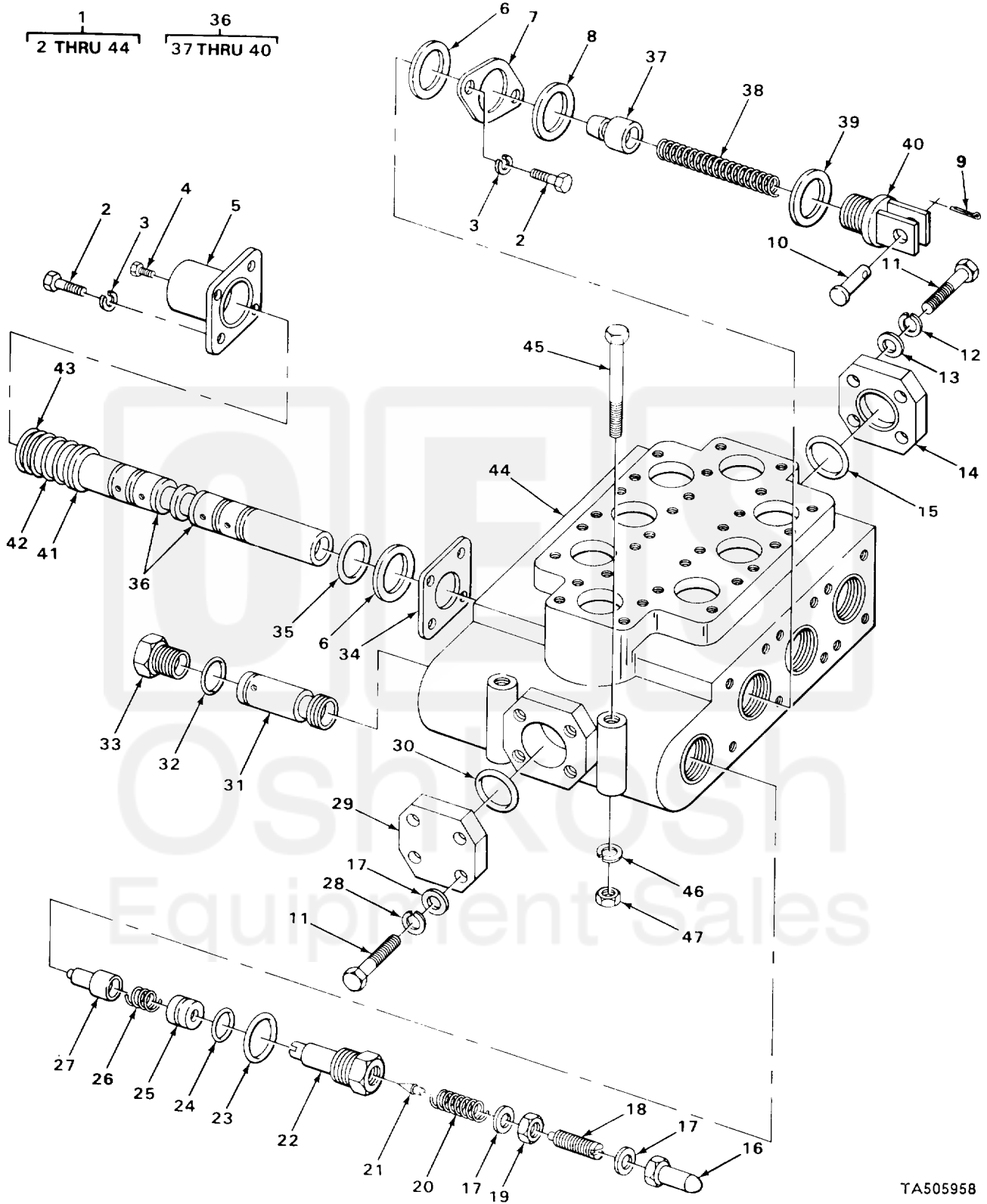

TA505958

FIGURE 155. THREE SPOOL CONTROL VALVE.

(1) ITEM NO	(2) SMR CODE	(3) CAGEC	(4) PART NUMBER	(5) DESCRIPTION AND USABLE ON CODES (UOC)	(6) QTY
GROUP 2402 MANIFOLD AND/OR CONTROL VALVES					
FIG. 155 THREE SPOOL CONTROL VALVE					
1	PAFFF	02892	V38DDD109MIL	VALVE,CONTROL ASSEMBLY	1
2	PFFZZ	96906	MS90725-6	SCREW,CAP,HEXAGON H WIPER MOUNTING	16
3	PFFZZ	96906	MS35338-44	WASHER,LOCK WIPER MTG	16
4	PFFZZ	02892	560X106A	GROMMET, PLUG COVER	3
* 5	XBFZZ	02892	M10X39	COVER,SPRING	3
6	PAFZZ	03476	31335	SEAL PLUNGER	3
7	KFFZZ	02892	521X95	RETAINER,PLATE PART OF KIT P/N SK0751	3
8	KFFZZ	02892	A1039X4	WIPER,PLUNGER HOUSING PART OF KIT P/N SK0751	3
9	PAFZZ	96906	MS24665-283	PIN,COTTER CONTROL VALVE LEVER PIN	1
10	PFFZZ	96906	MS20392-5C29	PIN,STRAIGHT,HEADED CONTROL VALVE LEVER	1
11	PFFZZ	96906	MS90728-110	SCREW,CAP,HEXAGON H VALVE COVER	8
12	PFFZZ	96906	MS35338-48	WASHER,LOCK VALVE COVER	4
13	PFFZZ	02892	A419X9	WASHER,FLAT	4
* 14	XBFZZ	02892	M17X123	COVER VALVE END	1
15	PAFZZ	02892	A791X31	PACKING,PREFORMED	1
* 16	XBFZZ	02892	A245X19	NUT,ACORN RELIEF VALVE	1
17	PFFZZ	02892	A418X6	WASHER,FLAT RELIEF VALVE	6
18	PFFZZ	02892	A234X17	SETSCREW	1
* 19	XBFZZ	02892	A249X5	NUT,PLAIN,HEXAGON RELIEF VALVE	1
* 20	XBFZZ	02892	A501X352	SPRING,HELICAL,COMP	1
21	PAFZZ	30379	9030294	DISK,VALVE	1
* 22	XBFZZ	02892	514X905	PLUG,MACHINE THREAD	1
23	PAFZZ	02892	A395X21	PACKING,PREFORMED	2
24	PAFZZ	02892	A395X18	PACKING,PREFORMED	1
25	PFFZZ	02892	414X206	SEAT,VALVE	1
* 26	XBFZZ	02892	A501X77	SPRING,HELICAL,COMP	1
27	PFFZZ	02892	513X118	PISTON,VALVE	1
28	PFFZZ	96906	MS35338-47	WASHER,LOCK END COVER	4
* 29	XBFZZ	02892	M17X119	COVER,END	1
30	PAFZZ	02892	A791X27	PACKING,PREFORMED	1
31	PFFZZ	02892	414X205	SEAT,VALVE	1
32	PFFZZ	02892	A395X23	PACKING,PREFORMED	2
* 33	XBFZZ	02892	514X904	CAP,VALVE RELIEF VALVE	1
* 34	XBFZZ	02892	521X120B	PLATE,RETAINING COVER TO HOUSING	3
35	PAFZZ	02892	A404X8	RING	3
* 36	XBFFF	02892	512X582K	PLUNGER ASSEMBLY	3
37	PFFZZ	02892	513X21	CHECK,PLUNGER PLUNGER	2
* 38	XBFZZ	02892	A501X282	SPRING,HELICAL, COMP	2
39	PAFZZ	02892	A395X19	O RING PLUNGER EYE	2
40	XAFZZ	02892	516X60	EYE PLUNGER,PUMP	1
* 41	XBFZZ	02892	416X105	SPRING,SPECIAL SPRING	6
42	PFFZZ	02892	A501X587	SPRING PLUNGER	3
* 43	XBFZZ	02892	514X561	CAP	3
* 44	XBFZZ	02892	537X79	HOUSING 3 SPOOL VALVE	1