

UNIT, DIRECT SUPPORT, AND GENERAL SUPPORT MAINTENANCE
REPAIR PARTS AND SPECIAL TOOLS LIST

EXTENDED SERVICE PROGRAM (ESP)

TRUCK, CARGO, 2-1/2-TON, 6X6, M44A3 SERIES TRUCKS (DIESEL)

M35A3, W/O WINCH (NSN 2320-01-383-2047); W/WINCH (NSN 2320-01-383-3850);

M35A3C, W/O WINCH (NSN 2320-01-383-2050); W/WINCH (NSN 2320-01-383-2049);

M36A3, W/O WINCH (NSN 2320-01-383-2048); W/WINCH (NSN 2320-01-383-2046).

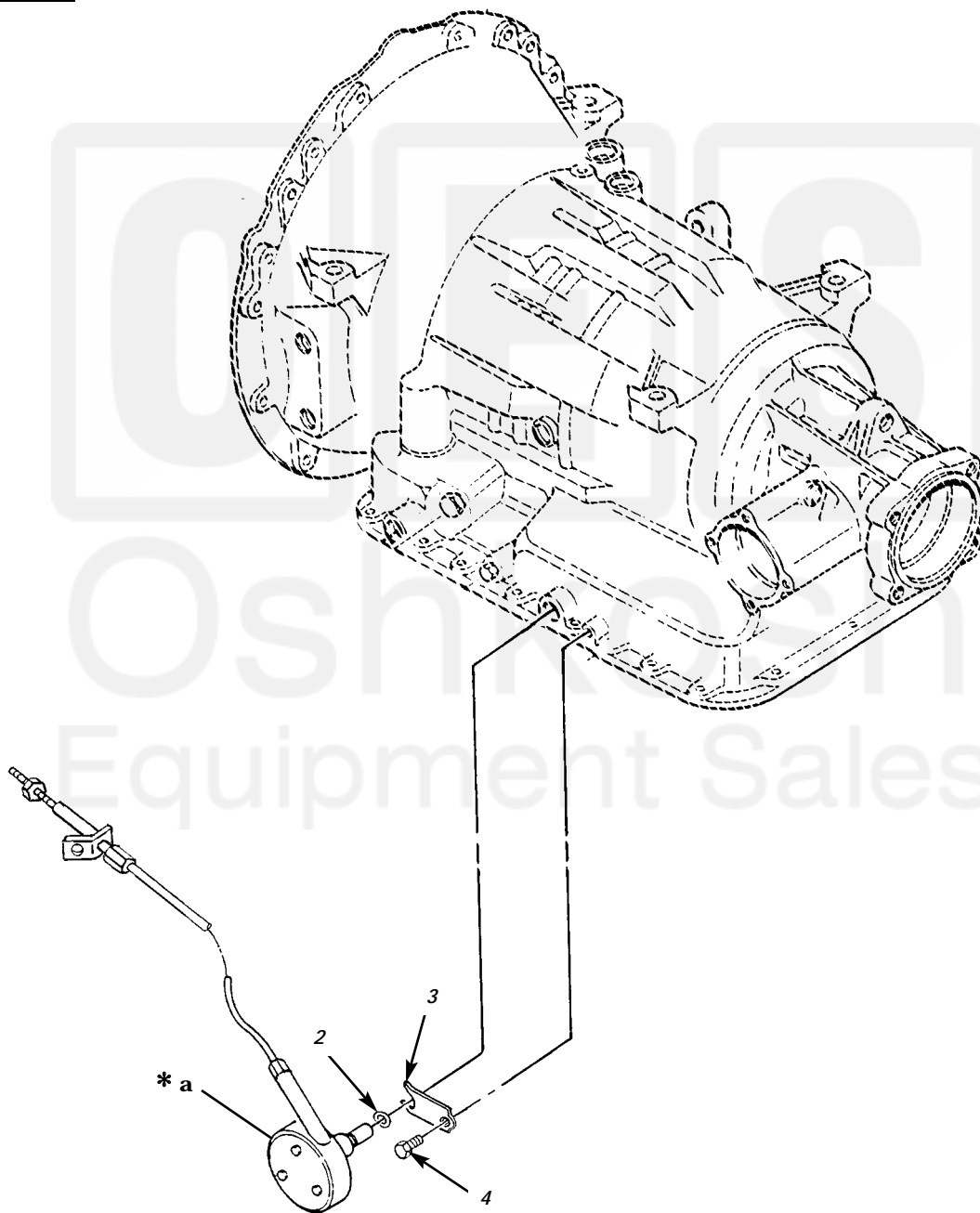
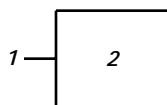

* a PART OF ITEM 1

Figure 81. Modulator Control.

Current part is item (3) on diagram. Available at www.oshkoshequipment.com

(1) ITEM NO	(2) SMR CODE	(3) NSN	TM9-2320-386-24P (4) CAGEC	(5) PART NUMBER	(6) DESCRIPTION AND USABLE ON CODES(UC)	0082 00 (7) QTY
					GROUP 0705 GEAR SHIFT	
					FIG. 81 MODULATOR CONTROL	
1	PAOOO	5895014282198	60602	98006-37	CONTROL,MODULATOR.....	1
2	PAOZZ	5330010435572	73342	8658110	.RETAINER,PACKING.....	1
3	PAOZZ	2520005576619	73342	8627650	RETAINER,MODULATOR.....	1
4	PAOZZ	5305013861711	73342	29500738	SCREW,MACHINE.....	1

END OF FIGURE



0082 00-1

Current part is item (3) on diagram. Available at www.oshkoshequipment.com