

UNIT, DIRECT SUPPORT, AND GENERAL SUPPORT MAINTENANCE  
REPAIR PARTS AND SPECIAL TOOLS LIST

EXTENDED SERVICE PROGRAM (ESP)

TRUCK, CARGO, 2-1/2-TON, 6X6, M44A3 SERIES TRUCKS (DIESEL)

M35A3, W/O WINCH (NSN 2320-01-383-2047); W/WINCH (NSN 2320-01-383-3850);  
M35A3C, W/O WINCH (NSN 2320-01-383-2050); W/WINCH (NSN 2320-01-383-2049);  
M36A3, W/O WINCH (NSN 2320-01-383-2048); W/WINCH (NSN 2320-01-383-2046).

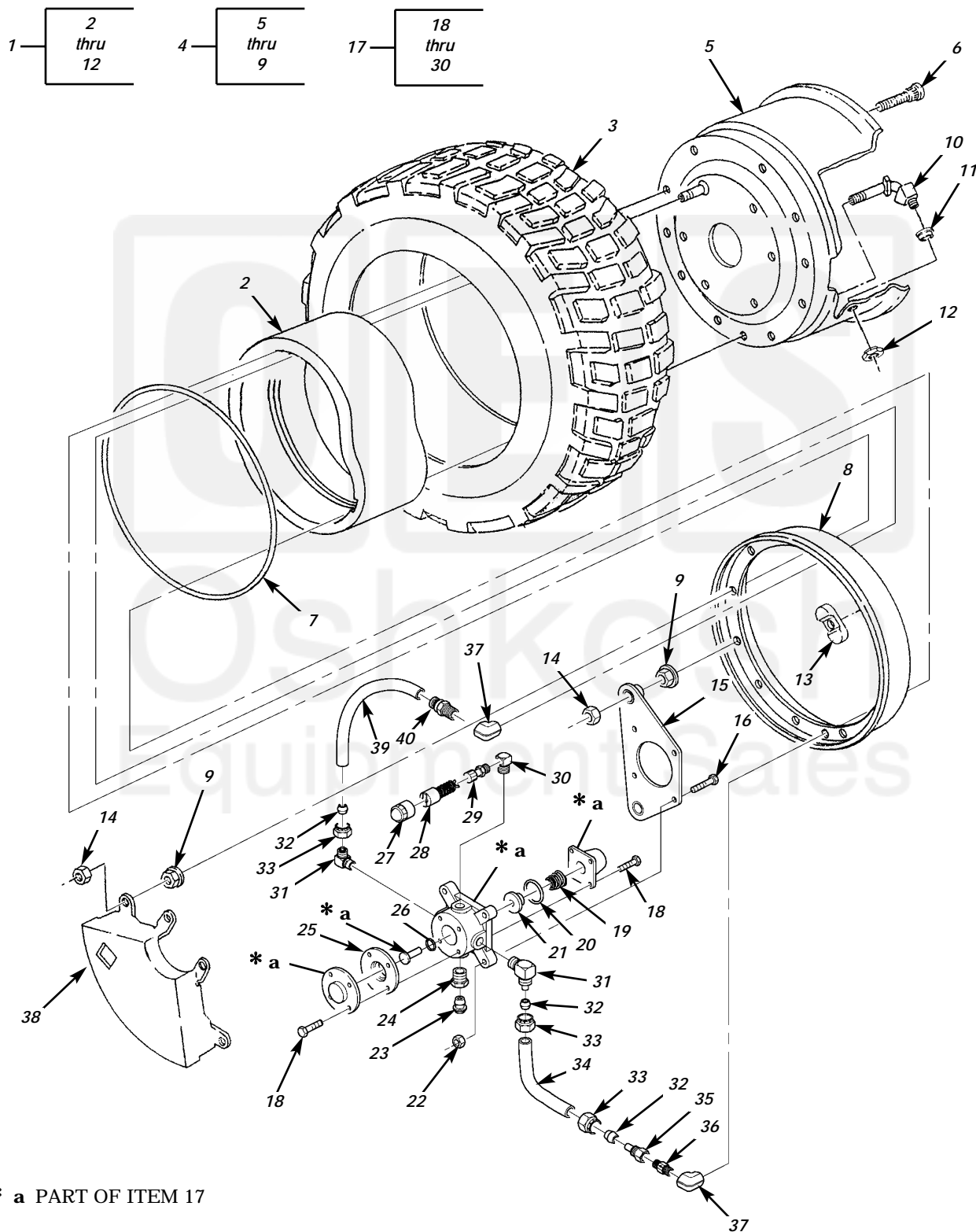

Figure 119. Tire, Wheel Assembly, and Wheel Valve.

| (1)<br>ITEM<br>NO                               | (2)<br>SMR<br>CODE | (3)<br>NSN    | TM9-2320-386-24P<br>(4)<br>CAGEC | (5)<br>PART<br>NUMBER | (6)<br>DESCRIPTION AND USABLE ON CODES(UOC)   | 0120 00<br>(7)<br>QTY |
|---|--------------------|---------------|----------------------------------|-----------------------|---|-----------------------|
| GROUP 1313 TIRES,TUBES,TIRE CHAINS              |                    |               |                                  |                       |   |                       |
| FIG. 119 TIRE,WHEEL ASSEMBLY,AND<br>WHEEL VALVE |                    |               |                                  |                       |   |                       |
| 1   | AOOO               |               | 34623                            | RCSK15411             | TIRE AND WHEEL ASSY.....  | 7                     |
| 2   | PAOZZ              | 2530013982022 | 34623                            | RCSK-15406            | .BEADLOCK,PNEUMATIC.....  | 1                     |
| 3   | PCOHH              | 2610013976976 | 19207                            | 12448698              | .TIRE,PNEUMATIC,VEHI.....   | 1                     |
| 4   | PAOOO              | 2530013983380 | 19207                            | 12448697              | .WHEEL,PNEUMATIC TIR.....   | 1                     |
| 5   | XAOZZ              |               | 41885                            | X90874                | ..RIM,INNER.....  | 1                     |
| 6   | PAOZZ              | 5306013146742 | 19207                            | 12363604              | ..BOLT,RIBBED SHOULDE.....  | 10                    |
| 7   | PAOZZ              | 5331013147598 | 19207                            | 12363606              | ..O-RING.....   | 1                     |
| 8   | XAOZZ              |               | 41885                            | X90876                | ..RING,OUTER.....   | 1                     |
| 9   | PAOZZ              | 5310011022711 | 19207                            | 12257242              | ..NUT,SELF-LOCKING,EX.....  | 10                    |
| 10  | PFOZZ              | 2640014297813 | 19207                            | 12448695              | .VALVE,PNEUMATIC TIR.....   | 1                     |
| 11  | PAOZZ              | 5325014375810 | 2W783                            | RG22                  | .GROMMET,NONMETALLIC.....   | 1                     |
| 12  | PAOZZ              | 5310014456872 | 2W783                            | HN80                  | .NUT,PLAIN HEXAGON.....   | 1                     |
| 13  | PAOZZ              | 3040014070644 | 19207                            | 12448971              | WEIGHT,COUNTERBALAN FRONT WHEELS<br>ONLY.....   | 1                     |
| 14  | PAOZZ              | 5310010453709 | 96906                            | MS51983-6             | NUT,PLAIN,SINGLE BA.....  | 24                    |
| 15  | PAOZZ              | 5340014224328 | 34623                            | RCSK17558             | PLATE,MOUNTING.....   | 6                     |
| 16  | PAOZZ              | 5305002253843 | 80204                            | B1821BH025C100N       | SCREW,CAP,HEXAGON H.....  | 24                    |
| 17  | PAOOO              | 2530014196303 | 19207                            | 12448915              | VALVE,BRAKE PNEUMAT.....  | 6                     |
| 18  | KFOZZ              |               | 0N0J4                            | 50001012              | .SCREW,CAP,HEXAGON H PART OF KIT P/N<br>50009501.....   | 8                     |
| 19  | KFOZZ              |               | 0N0J4                            | 50001501              | .SPRING PART OF KIT P/N 50009501....  | 1                     |
| 20  | KFOZZ              |               | 0N0J4                            | 50009011              | .PACKING,PREFORMED PART OF KIT P/N<br>50009501.....   | 1                     |
| 21  | KFOZZ              |               | 0N0J4                            | 50004106              | .POPPET PART OF KIT P/N 50009501....  | 1                     |
| 22  | PAOZZ              | 5310000614650 | 96906                            | MS51943-31            | .NUT,SELF-LOCKING,HE.....   | 4                     |
| 23  | KFOZZ              |               | 0N0J4                            | 50009402              | .VALVE,CHECK PART OF KIT P/N<br>50009501.....   | 1                     |
| 24  | PAOZZ              | 2520013644486 | 0N0J4                            | 50005023              | .BREATHER.....  | 1                     |
| 25  | KFOZZ              |               | 0N0J4                            | 50009401              | .DIAPHRAM PART OF KIT P/N 50009501..  | 1                     |
| 26  | KFOZZ              |               | 0N0J4                            | 50009012              | .PACKING,PREFORMED PART OF KIT P/N<br>50009501.....   | 1                     |
| 27  | PAOZZ              | 2640000603550 | 53705                            | 2316                  | .CAP,PNEUMATIC VALVE.....   | 1                     |
| 28  | PAOZZ              | 2640000048297 | 27783                            | 8500V                 | .VALVE CORE.....  | 1                     |
| 29  | PFOZZ              | 4820013638002 | 0N0J4                            | 50003050              | .VALVE,PNEUMATIC TAN.....   | 1                     |
| 30  | PAOZZ              | 4730006399730 | 79470                            | 3400X2W               | .ELBOW,PIPE.....  | 1                     |
| 31  | PAOZZ              | 4730011157362 | 81343                            | 8-4 100202BA          | ELBOW,PIPE TO TUBE.....   | 12                    |
| 32  | PAOZZ              | 4730010491559 | 81343                            | 8 100115B             | SLEEVE,COMPRESSION,.....  | 18                    |
| 33  | PAOZZ              | 4730010487874 | 81343                            | 8 100110B             | NUT,TUBE COUPLING.....  | 18                    |
| 34  | MOOZZ              |               | 19207                            | CPR104420-3-6         | TUBE,NONMETALLIC MAKE FROM HOSE,<br>NONMETALLIC,P/N CPR104420-3,NSN<br>4720-01-003-6706,5.50 INCHES LONG... | 6                     |
| 35  | PAOZZ              | 4730011346994 | 81343                            | 8-6 100103BA          | ADAPTER,STRAIGHT,PI.....  | 6                     |
| 36  | PAOZZ              | 2940014438959 | 19207                            | 12448913              | FILTER,FLUID.....   | 6                     |
| 37  | PAOZZ              | 4730002775543 | 02978                            | 12353                 | ELBOW,PIPE.....   | 12                    |
| 38  | PFOZZ              | 2530014478996 | 19207                            | 12448972              | HUB CAP,WHEEL.....  | 6                     |
| 39  | MOOZZ              |               | 19207                            | CPR104420-3-9         | TUBE,NONMETALLIC MAKE FROM HOSE,<br>NONMETALLIC,P/N CPR104420-3,NSN   | 6                     |

Current part is item (6) on diagram. Available at [www.oshkoshequipment.com](http://www.oshkoshequipment.com)

| (1)<br>ITEM<br>NO | (2)<br>SMR<br>CODE | (3)<br>NSN    | (4)<br>CAGEC | (5)<br>PART<br>NUMBER | (6)<br>DESCRIPTION AND USABLE ON CODES(UC)                       | (7)<br>QTY |
|-------------------|--------------------|---------------|--------------|-----------------------|--|------------|
| 40                | PAOZZ              | 4730013990896 | 19207        | 12448639-7            | 4720-01-003-6706,8.12 INCHES LONG...<br>ADAPTER,STRAIGHT,PI..... | 6          |

END OF FIGURE



0120 00-2

Current part is item (6) on diagram. Available at [www.oshkoshequipment.com](http://www.oshkoshequipment.com)