

UNIT, DIRECT SUPPORT, AND GENERAL SUPPORT MAINTENANCE
REPAIR PARTS AND SPECIAL TOOLS LIST
TRUCK, 5-TON, 6X6, M809 SERIES TRUCKS (DIESEL)

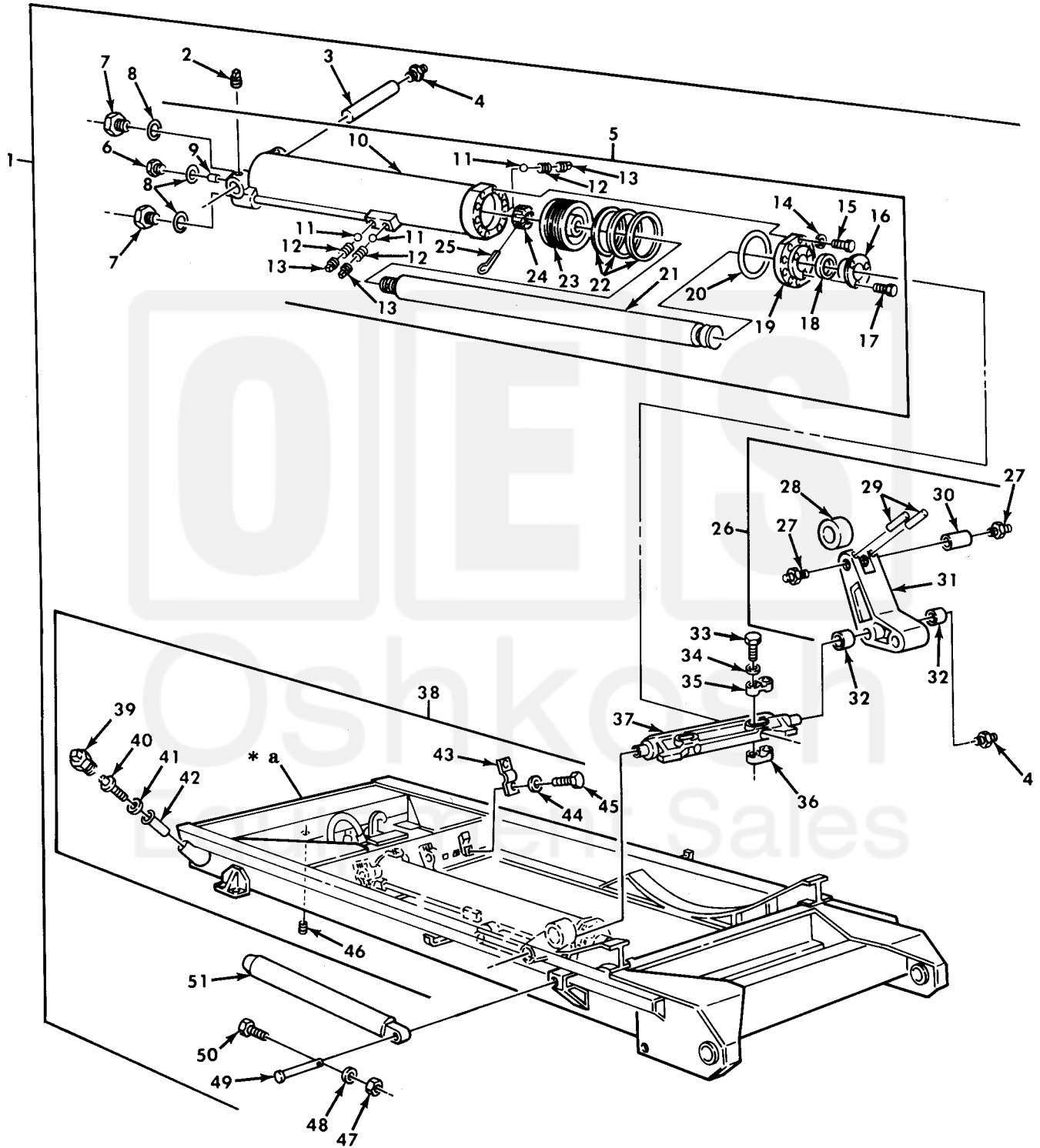

* a PART OF ITEM 38

Figure 377. Dump Hydraulic Hoist Assembly.

| (1) ITEM NO | (2) SMR CODE | (3) NSN | (4) CAGEC | (5) PART NUMBER | (6) DESCRIPTION AND USABLE ON CODE (UOC) | (7) QTY |
|-------------------|--------------------|------------------|--------------|-----------------------|---|------------|
| 30 | PAFZZ | 5315-00-740-9020 | 19207 | 7409020 | UOC: 627, 633 .. PIN, GROOVED, HEADLES..... | 1 |
| 31 | PAFZZ | 2520-00-740-9041 | 19207 | 7409041 | UOC: 627, 633 .. BELL CRANK..... | 1 |
| 32 | PAFZZ | 3120-00-740-9299 | 19207 | 7409299 | UOC: 627, 633 .. BEARING, SLEEVE..... | 2 |
| 33 | PAFZZ | 5305-00-269-3244 | 80204 | B1821BH038F250N | UOC: 627, 633 .. SCREW, CAP, HEXAGON H..... | 4 |
| 34 | PAFZZ | 5310-00-637-9541 | 96906 | MS35338-46 | UOC: 627, 633 .. WASHER, LOCK..... | 4 |
| 35 | PAFZZ | 5342-01-217-8306 | 19207 | 7409037 | UOC: 627, 633 .. FAIRLEAD HALF, TUBUL..... | 2 |
| 36 | PAFZZ | 5340-01-205-5957 | 19207 | 7409038 | UOC: 627, 633 .. STEEL STOCK ASSORTM..... | 2 |
| 37 | PAFZZ | 2590-00-332-0095 | 19207 | 7971949 | UOC: 627, 633 .. CROSSHEAD, HYDRAULIC..... | 1 |
| 38 | PAFZZ | 2510-00-231-7446 | 19207 | 11608807 | UOC: 627, 633 .. FRAME, HOIST, BODY, DU..... | 1 |
| 39 | PAFZZ | 4730-01-123-4546 | 19207 | 7409027 | UOC: 627, 633 .. PLUG, PIPE..... | 1 |
| 40 | PAFZZ | 6680-00-740-9026 | 19207 | 7409026 | UOC: 627, 633 .. GAGE ROD, LIQUID LEV DUMP HOIST FRAME..... | 1 |
| 41 | PAFZZ | 5365-00-182-9635 | 19207 | 7409080 | UOC: 627, 633 .. SPACER, RING..... | 1 |
| 42 | PAFZZ | 4330-01-168-6891 | 19207 | 7409025 | UOC: 627, 633 .. FILTER ELEMENT, FLUI..... | 1 |
| 43 | PAFZZ | 3110-00-999-6469 | 19207 | 8758374 | UOC: 627, 633 .. BEARING, CAP AND BAS..... | 4 |
| 44 | PAFZZ | 5310-00-584-7888 | 96906 | MS35338-51 | UOC: 627, 633 .. WASHER, LOCK..... | 8 |
| 45 | PAFZZ | 5305-00-916-2345 | 80204 | B1821BH075F200N | UOC: 627, 633 .. SCREW, CAP, HEXAGON H..... | 8 |
| 46 | PAFZZ | 4730-01-135-8310 | 96906 | MS49006-8 | UOC: 627, 633 .. PLUG, PIPE, MAGNETIC..... | 1 |
| 47 | PAFZZ | 5310-00-768-0319 | 96906 | MS51968-2 | UOC: 627, 633 .. NUT, PLAIN, HEXAGON..... | 2 |
| 48 | PAFZZ | 5310-00-582-5965 | 96906 | MS35338-44 | UOC: 627, 633 .. WASHER, LOCK..... | 2 |
| 49 | PAFZZ | 5315-01-416-1809 | 19207 | 12375688 | UOC: 627, 633 .. PIN, STRAIGHT, HEADED..... | 2 |
| 50 | PAFZZ | 5305-00-267-8957 | 80204 | B1821BH025F175N | UOC: 627, 633 .. SCREW, CAP, HEXAGON H..... | 2 |
| 51 | PAFZZ | 2510-00-786-4631 | 19207 | 7409023 | UOC: 627, 633 .. BRACE ASSEMBLY..... | 2 |

END OF FIGURE